

9 8 7 6 5 4 3 2 1

E
D
C
B
A

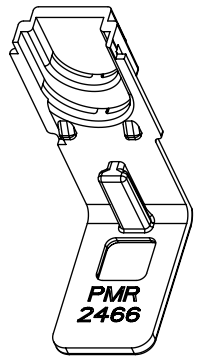
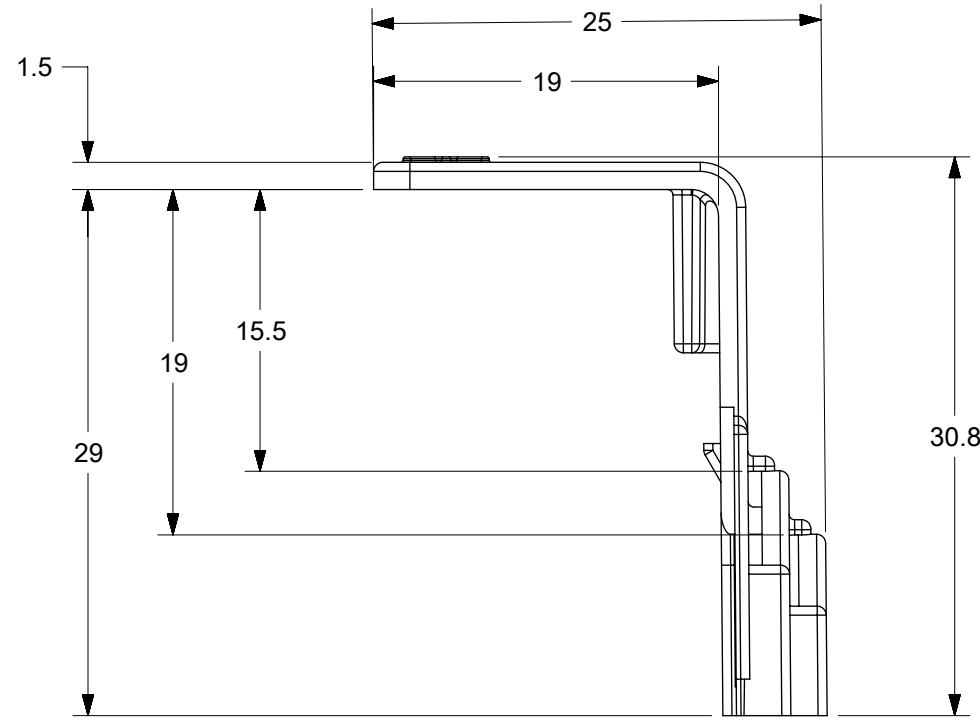
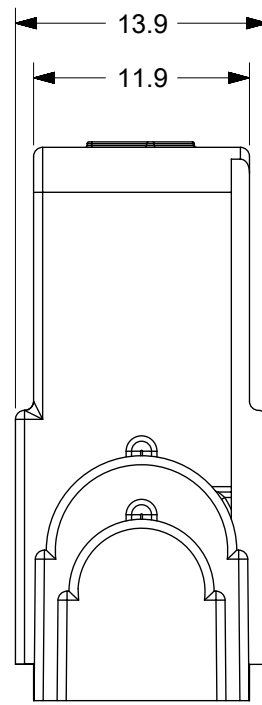
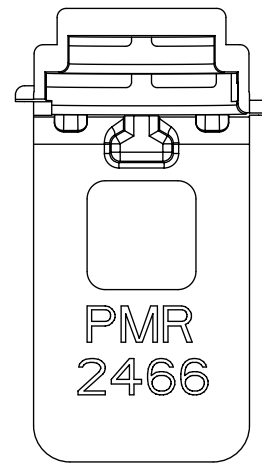

MATERIAL: POLYAMIDE

TOLERANCE	>0.5=3	>3=6	>6=30	>30=120	>120=400
ISO 2768-m	±0.1	±0.1	±0.2	±0.3	±0.5

THIS DRAWING CONTAINS INFORMATION THAT IS PROPRIETARY TO MOLEX ELECTRONIC TECHNOLOGIES, LLC AND SHOULD NOT BE USED WITHOUT WRITTEN PERMISSION

EC NO: 120665 DRWN: WLEUNG CHKD: DNGUYEN62 APPR: JFMURPHY	2017/08/14 2017/08/15 2017/08/18	GENERAL TOLERANCES (UNLESS SPECIFIED) ANGULAR TOL ± °	DIMENSION UNITS: mm SCALE: NTS					
	4 PLACES ± 3 PLACES ± 2 PLACES ± 1 PLACE ± 0 PLACES ±	DRWN BY: WLEUNG DATE: 2017/08/14	CHK'D BY: DNGUYEN62 DATE: 2017/08/15				MX-KEL61 TERMINAL SHROUD FOR MX-KE61 & MX-KE66	
	DRAFT WHERE APPLICABLE MUST REMAIN WITHIN DIMENSIONS	APPR BY: JFMURPHY DATE: 2017/08/18	DRAWING SIZE: B THIRD ANGLE PROJECTION	PRODUCT CUSTOMER DRAWING				
	A	REV	B				SERIES: 201606 MATERIAL NUMBER: 2016066947	CUSTOMER

RELEASE STATUS	P1	RELEASE DATE	18.08.2017	19:46:39
----------------	----	--------------	------------	----------

9 8 7 6 5 4 3 2 1

FORMAT: master-lb-prod-B
 REVISION: C
 DATE: 2015/12/14