

Current rating:25A AC/DC
 额定电流: 25A AC/DC
 Temperature range:-40°C~+125°C
 温度范围: -40°C~+125°C

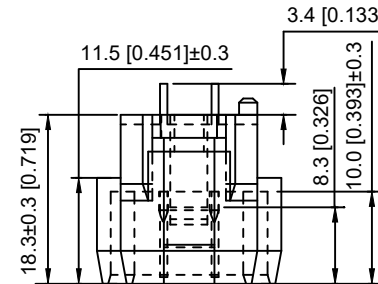

K 828801 W V - 2xXX - PT SN
 ① ② ③ ④ ⑤ ⑥ ⑦

- 1.K: XKBTEK-Car Connector
- 2.XKB Series No
- 3.Category:W-Wafer
- 4.Welding Board Range:V-Stright 180°
- 5.Row No.Pin No:2xXX-2x09 Pin
- 6.Material:PT-PBT
- 7.Palting:SN-Plated Tin

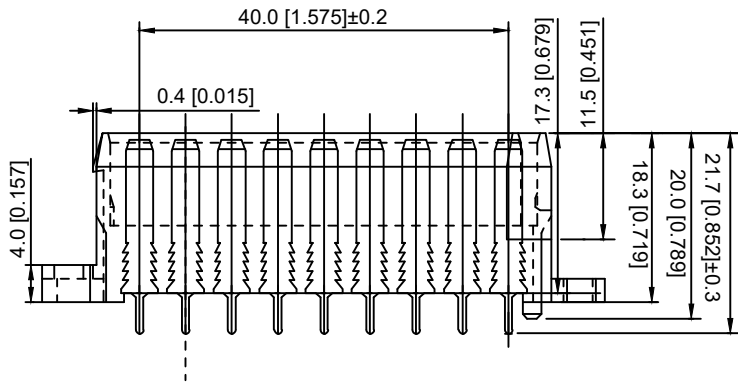
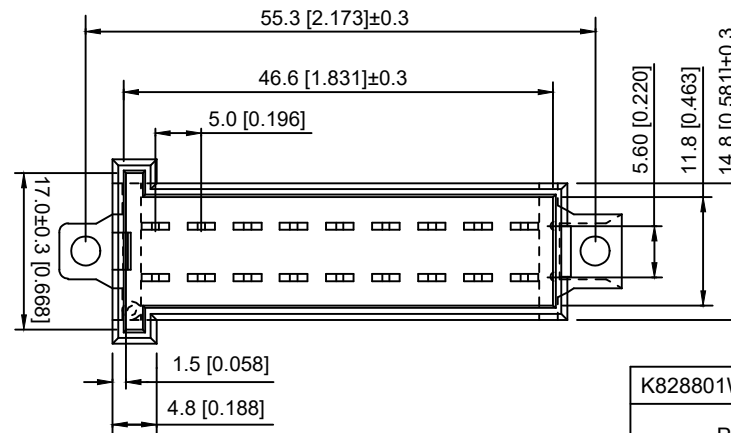
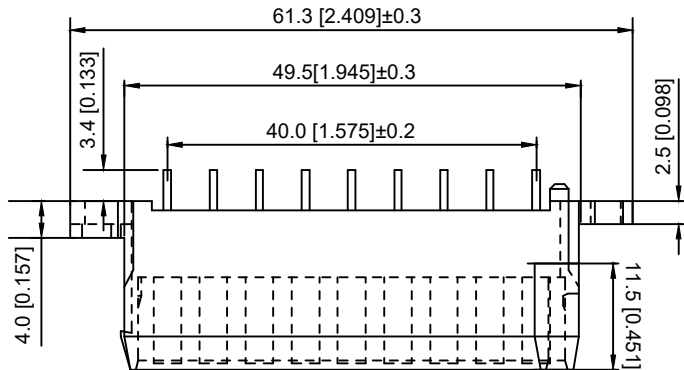

K828801WV-2xXX-PTS	PBT	Brass	K828801H
PART NO	Material	Material(Pin)	Suitable XKB Housing

DSND	SCALE: N/A	MODEL TYPE: 5.0mm Automobile connector
DWN	VIEW:	PART NO.: K828801WV-2xXX-PTS
CHKD	UNIT: mm/in	DWG NO.: X-K828801WV-2xXX-PTS
APPD	SIZE: A4	

					ANGLAR	±5°
ΔX					L ≤ 4	±0.2
ΔX					4 < L ≤ 16	±0.3
ΔX					16 < L ≤ 63	±0.4
MARK					L > 63	±0.5
REVISIONS					UNSPECIFIED TOLERANCES	



XKB INDUSTRIAL PRECISION CO., LIMITED

WEIGHT	SHEET	REVISION
	1/1	A0