

LOOSE PIECE		SPECIFICATIONS						
MATERIAL NUMBER	ALTERNATE NUMBER	STUD SIZE	'S" ±.005/(0.13)	'W" ±.010/(0.25)	'C" MIN.	'L" MAX.	'ID" MIN.	STOCK THICKNESS
190440063	A-120-02	2	.094/(2.39)	.225/(5.72)	.157/(3.99)	.563/(14.30)	.062/(1.57)	.028/(1.71)
190440064	A-120-04	4	.119/(3.02)	.225/(5.72)	.157/(3.99)	.563/(14.30)	.062/(1.57)	.028/(1.71)
190440066	A-120-06	6	.146/(3.71)	.225/(5.72)	.157/(3.99)	.563/(14.30)	.062/(1.57)	.028/(1.71)
190440068	A-121-06	6	.146/(3.71)	.312/(7.92)	.270/(6.86)	.720/(18.29)	.062/(1.57)	.028/(1.71)
190440069	A-121-08	8	.173/(4.39)	.312/(7.92)	.270/(6.86)	.720/(18.29)	.062/(1.57)	.028/(1.71)
190440072	A-121-10	10	.198/(5.03)	.312/(7.92)	.270/(6.86)	.720/(18.29)	.062/(1.57)	.028/(1.71)
190440075	A-122-14	1/4	.265/(6.73)	.467/(11.86)	.386/(9.80)	.914/(23.22)	.062/(1.57)	.028/(1.71)
190440077	A-122-56	5/16	.328/(8.33)	.467/(11.86)	.386/(9.80)	.914/(23.22)	.062/(1.57)	.028/(1.71)
190440078	A-126-10	10	.198/(5.03)	.534/(13.56)	.552/(14.02)	1.113/(28.27)	.054/(1.37)	.031/(1.79)
190440079	A-126-14	1/4	.265/(6.73)	.534/(13.56)	.552/(14.02)	1.113/(28.27)	.054/(1.37)	.031/(1.79)
190440082	A-126-56	5/16	.328/(8.33)	.534/(13.56)	.552/(14.02)	1.113/(28.27)	.054/(1.37)	.031/(1.79)
190440081	A-126-38	3/8	.390/(9.91)	.534/(13.56)	.552/(14.02)	1.113/(28.27)	.054/(1.37)	.031/(1.79)
190440083	A-132-04	4	.126/(3.20)	.256/(6.45)	.240/(6.10)	.661/(16.69)	.062/(1.57)	.028/(1.71)
190440084	A-132-06	6	.146/(3.71)	.256/(6.45)	.240/(6.10)	.661/(16.69)	.062/(1.57)	.028/(1.71)
190440086	A-132-08	8	.173/(4.39)	.256/(6.45)	.240/(6.10)	.661/(16.69)	.062/(1.57)	.028/(1.71)

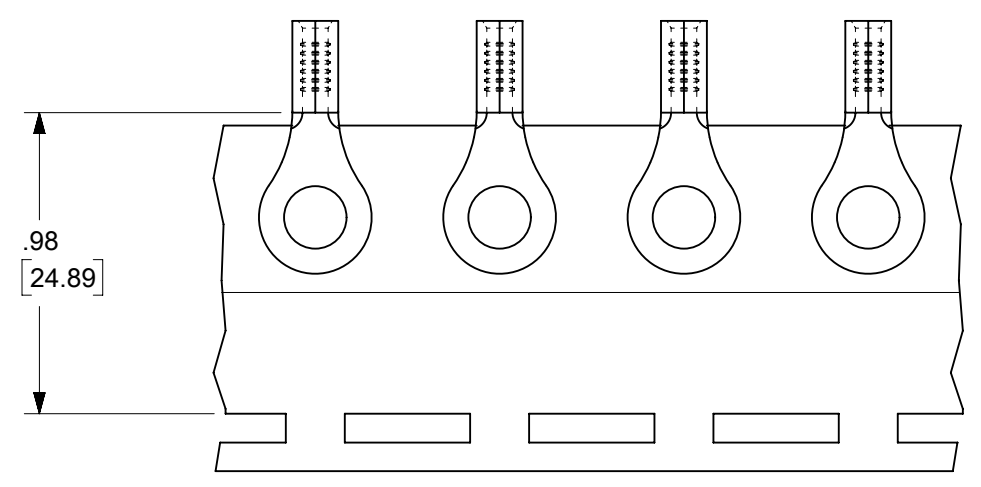
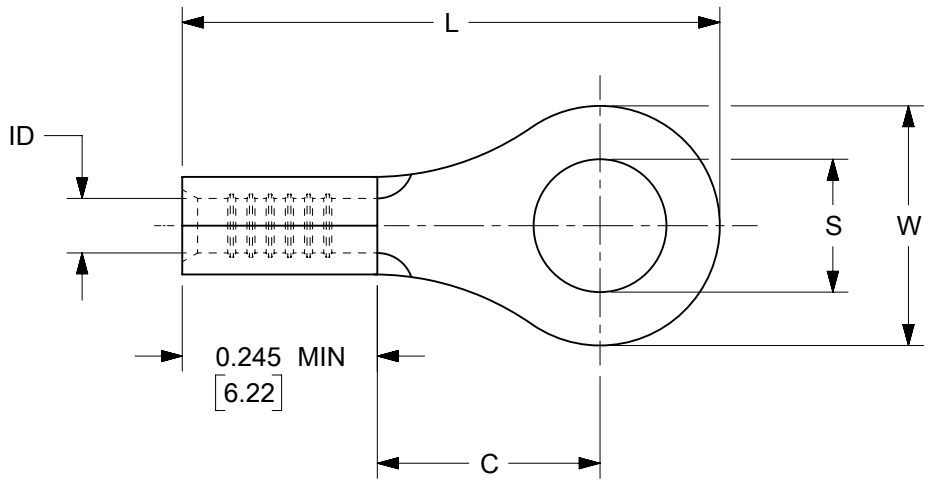

SEE TABLE FOR TAPE MOUNTED PARTS

1. MATERIAL : COPPER
2. PLATING : ELECTRO-TIN
3. PARTS ARE RoHS COMPLIANT.

THIS DRAWING CONTAINS INFORMATION THAT IS PROPRIETARY TO MOLEX ELECTRONIC TECHNOLOGIES, LLC AND SHOULD NOT BE USED WITHOUT WRITTEN PERMISSION											
DIMENSION UNITS INCH/mm		SCALE NTS		CURRENT REV DESC: REMOVED OBSOLETE PART NUMBER AS PER PCN#512606.				<b>molex</b>		RING TONGUE TERMINAL 22-18 AWG KRIMPTITE, 100 SERIES	
GENERAL TOLERANCES (UNLESS SPECIFIED)				EC NO: 764691 DRWN: RAVINR1 CHKD: GGA APPR: GGA							
4 PLACES ±		±		2023/09/01				PRODUCT CUSTOMER DRAWING		DOCUMENT NUMBER	
3 PLACES ±		± 0.005		2023/10/13				SD-19044-001		DOC TYPE   DOC PART   REVISION	
2 PLACES ±		± 0.13 ± 0.01		2023/10/13				PSD		001   C5	
1 PLACE ±		±		INITIAL REVISION:				MATERIAL NUMBER		CUSTOMER	
0 PLACES ±		±		DRWN: HEB APPR: RWD				1999/10/27 1999/10/27		GENERAL MARKET	
ANGULAR TOL ± °		± °		THIRD ANGLE PROJECTION		DRAWING		SERIES		SHEET NUMBER	
DRAFT WHERE APPLICABLE MUST REMAIN WITHIN DIMENSIONS		THIRD ANGLE PROJECTION		DRAWING		B-SIZE		19044		1 OF 1	