

This document is the property of Amphenol Corporation and is intended for the specific condition that it is not to be distributed, reproduced or used, in any form or by any means, without the prior consent of Amphenol Corporation. Any use of this document without its prior consent, in whole or in part, or to use any information in this document, is prohibited.

Customer drawing

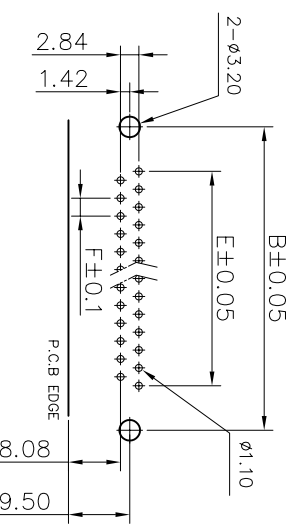

RECOMMENDED P.C.B. LAYOUT
(TOLERANCE +/-0.03)

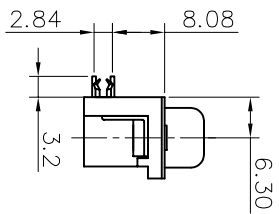
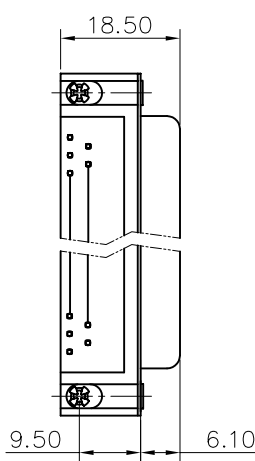
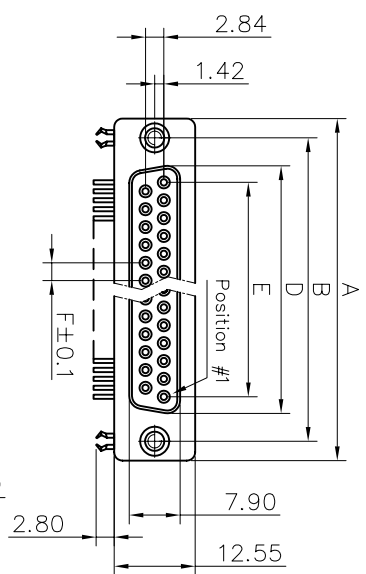

Positions	Dimensions					
	A	B	D	E	F	
9	30.81	24.99	16.24	10.96	2.74	
15	39.14	33.32	24.56	19.18	2.74	
25	53.04	47.04	38.38	33.24	2.77	
37	69.32	63.50	54.76	49.86	2.77	

REVISIONS			
S/N	EDN	DESCRIPTION	DATE
A			03/14/08

D-SUB TECHNICAL DATA

SHELL : Steel, 2.5um(100u") min. tin over 1.25um(50u") min. nickel
BODY : Glass filled thermoplastic.
 Flame retardant to UL94 V-0 Color Black
CONTACTS : Phosphor bronze
 0.76um(30u") min. gold over 1.25um(50u") min. nickel in mating area.
 2.5um(100u") min. tin over 1.25um(50u") min. nickel on termination area.
REAR INSERT : Brass, (100u") min. tin over 50u" min. nickel
BOARDLOCK : Brass, (100u") min. tin over 50u" min. nickel
SCREWLOCK : Brass, (100u") min. tin over 50u" min. nickel
ELECTRICAL : Voltage rating: 250 V RMS at 50 Hz
 Current rating: 5A per contact
 Withstanding Voltage >1000 V RMS at 50 Hz for one minute
 Insulation resistance >5000 M Ohms
 Contact resistance >20 mOhms max.
CUMMATIC : Temperature range -55 °C up to 155°C
MARKING : Amphenol...(Series No.)
 Manufacturing date
 Commercial reference

PRODUCT CODE

L 77SD X XX S A4 CH 4R C309

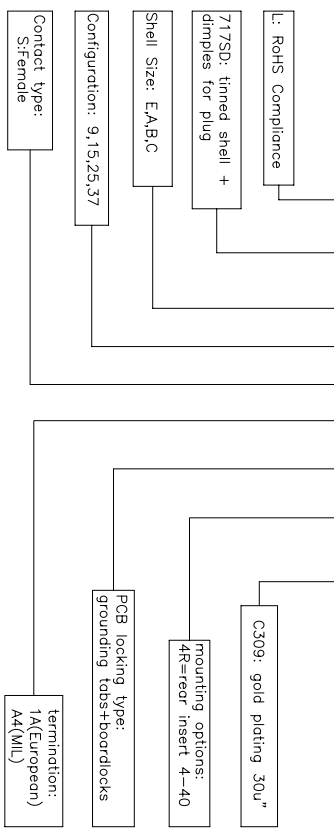

DIMENSIONAL SPECIFICATIONS		APPROVAL		DATE	
TOLERANCES	U.S.	DRAWN	Checked	DATE	DATE
	METRIC	Sumit	Sumit	09/14/08	09/14/08
X	±0.50	CHECKED	CHECKED	09/14/08	09/14/08
XX	±0.30				
XXX	±0.20				
FINISHES	±0.20				
ANGLES	2°				

FOR MATERIALS AND FINISHES		DRAWING FILE :	
REMOVE SHARP EDGES	REMOVE SHARP EDGES	ANGLE OF PROJECTION	ANGLE OF PROJECTION
THIRD ANGLE	THIRD ANGLE	AS SHOWN	AS SHOWN

TITLE		SIZE		DRAWING NO.	
D-SUB contacts , SD series		A4		C L77SDXXXS A4CH4RC309	
SCALE	NONE	SHEET	1	OF	1

Amphenol