

BOX ENCLOSURES-USA  
28915 N. Herky Dr #107  
LAKE BLUFF, IL 60044  
TEL: 847-932-4700  
FAX: 847-932-4701  
E-Mail - sales@boxenclosures.com

BOX ENCLOSURES-UK  
1 Ash Grove  
Keighley England B020705  
TEL: +44 (0) 1535 636 856  
FAX: +44 (0) 1535 637 737

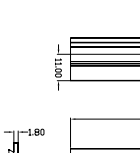

OPTIONAL ACCESSORY

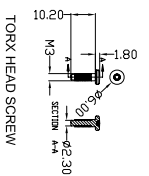
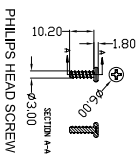
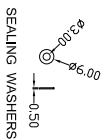
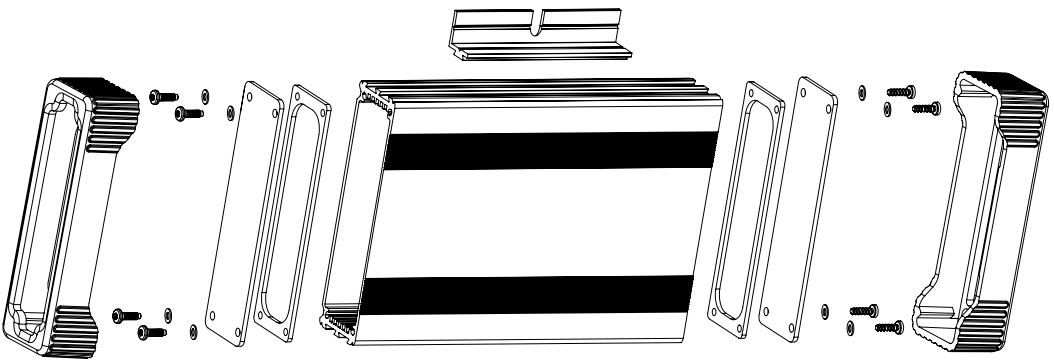
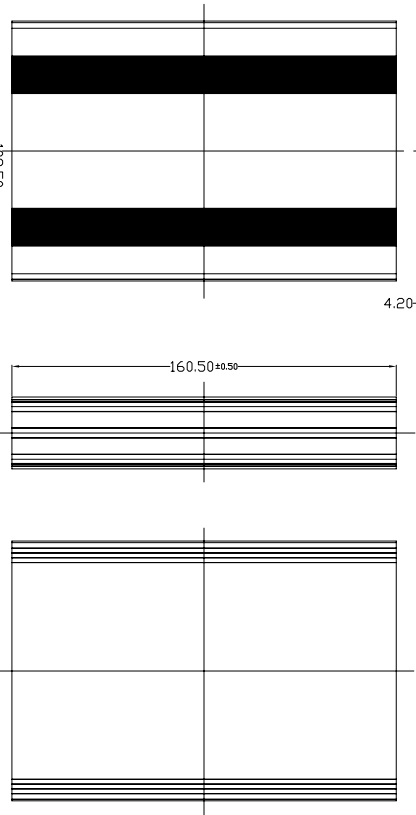
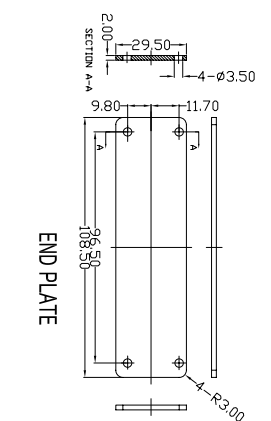
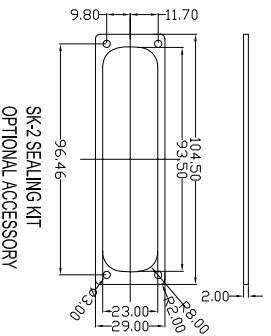

ENCLOSURE PROFILE

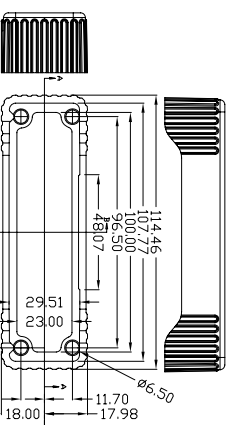
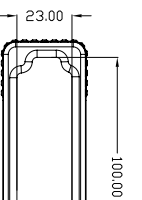

EC2 End Cap Optional Accessory

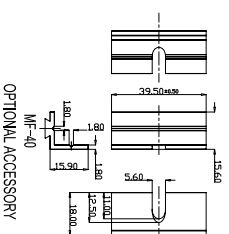
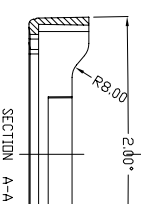

OPTIONAL ACCESSORY

COLOR LEGEND

| Part #    | Color                            | Description  |
|-----------|----------------------------------|--|
| B2-160 BK | Black                            | Black  |
| B2-160 BL | Blue                             | Blue   |
| B2-160 GR | Green                            | Green  |
| B2-160 RD | Red                              | Red  |
| B2-160 SI | Silver                           | Silver   |
| SK-2      | Sealing Kit - Optional Accessory |  |
| EC-2RD    | Red                              | NEM 4/jp65 Sealing kit for All B-2 Series Enclosures |
| EC-2GY    | Gray                             |  |



ENCLOSURES & ASSEMBLY SERVICES

Title

B2-160 MASTER DRAWING

Revision:

Material:

Aluminum 6063-T6(H16)

Finish:

Anodized BS 1615



TOLERANCE

all dimension in mm unless otherwise specified  
 .X ±0.40  
 .XX ±0.20  
 .XXX ±0.10  
 ANGLE ±1°

Dwn. Date

PAN 2009-04-08

App. Date

DATE