

APPROVED: \_\_\_\_\_  
 DATE: \_\_\_\_\_ TITLE: \_\_\_\_\_

Rev	AWO #	Description	Date	Appr
-		RELEASED	3/20/17	
A		UPDATE DRAWING	3/18/20	LH/DH

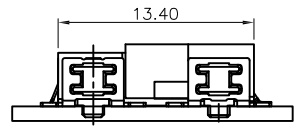
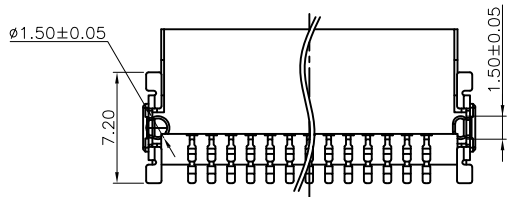
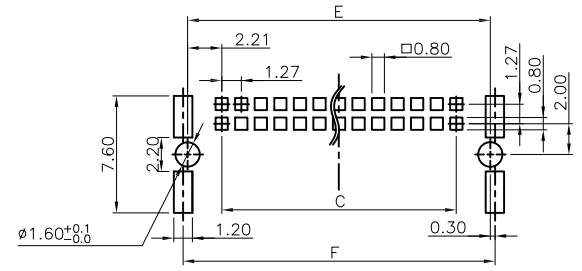
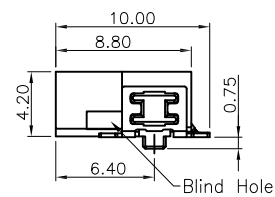
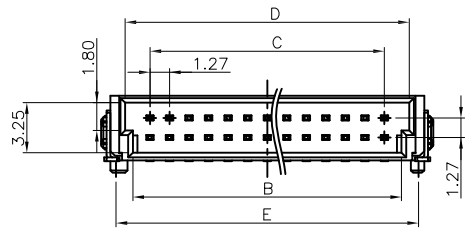
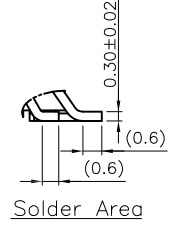
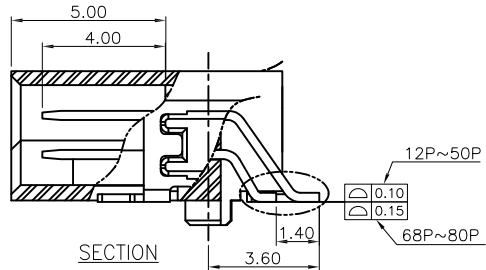
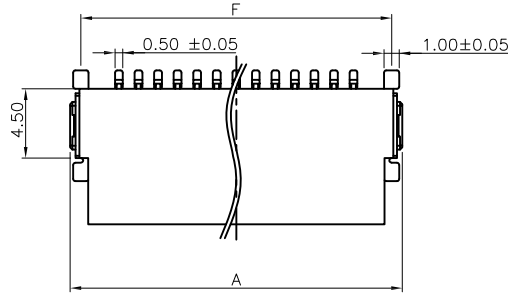

SMC Connector Board To Board Mating Length

Pin No.	A	B	C	D	E	F
12	12.70	8.57	6.35	9.57	10.77	11.34
16	15.24	11.11	8.89	12.11	13.31	13.88
20	17.78	13.65	11.43	14.65	15.85	16.42
26	21.59	17.46	15.24	18.46	19.66	20.23
30	24.13	20.00	17.78	21.00	22.20	22.77
32	25.40	21.27	19.05	22.27	23.47	24.04
40	30.48	26.35	24.13	27.35	28.55	29.12
50	36.83	32.70	30.48	33.70	34.90	35.47
68	48.26	44.13	41.91	45.13	46.33	46.90
80	55.88	51.75	49.53	52.75	53.95	54.52

**SPECIFICATIONS:**  
 Material:  
 Insulator: Hi-temp thermoplastic, rated UL 94V-0  
 Insulator color: Black  
 Contacts: Phosphor Bronze  
 Board Lock: Brass, Tin plated  
 Plating:  
 Gold flash over Nickel underplate on contact area,  
 Tin over Nickel underplate on solder tails  
 Electrical:  
 Current rating: 1.2 Amp max  
 Contact resistance: 25 mohms max  
 Insulation resistance: 1000 Mohms min  
 Withstanding voltage: 500 VAC for 1 minute  
 Temperature Rating:  
 Operating temperature: -55°C to +125°C  
 Environmental:  
 Lead free, RoHS compliant.



PACKAGED ON TAPE & REEL

UNLESS OTHERWISE SPECIFIED ALL DIMENSIONS ARE MILLIMETERS TOLERANCES: EXCEPT AS NOTED	
MM	ANGLE
X.X ± 0.35	± 2°
X.XX ± 0.20	
X.XXX ± 0.10	
APPROVALS	
DRAWN	DATE
CHECKED	
APPROVED	

**ADAM TECH INTERCONNECTS** 909 Rahway Avenue, Union, NJ 07083  
 Phone: 908-687-5000 Fax: 908-687-5710

TITLE: 1.27mm BOARD TO BOARD STACKING CONNECTOR, MALE, RIGHT ANGLE, SMT TYPE

SIZE	PART NO.	REV.
X	ESMC-M-XX-SGR-SMT-T/R	A

REF: S00242T SCALE: NTS SHEET 1 OF 1

6 5 4 3 2 1

6 5 4 3 2 1