

| 修订 REV | 标记 MARK | 修改摘要 REVISION DESCRIPTION | 签名 SIGNATURE | 日期 DATE |
|-----------|------------|------------------------------|-----------------|------------|
| A0 | | NEW RELEASE | 黄艳兰 | 2013-06-11 |

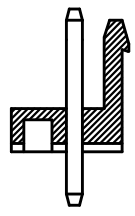
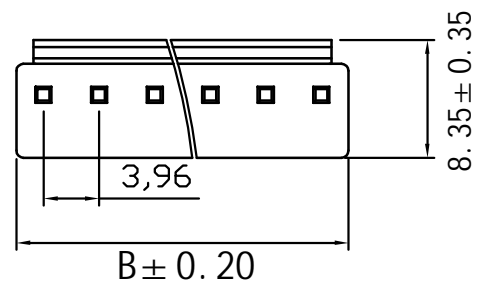
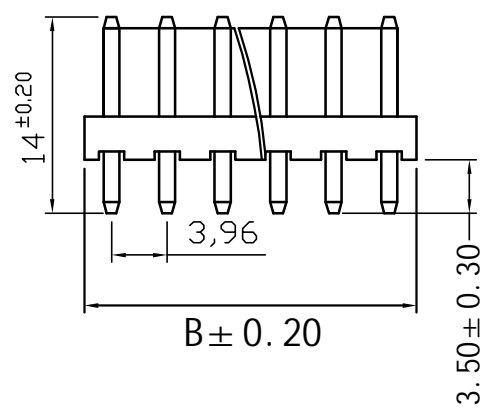
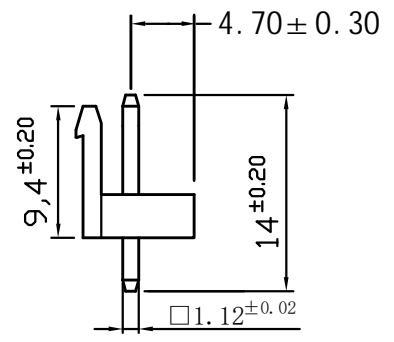
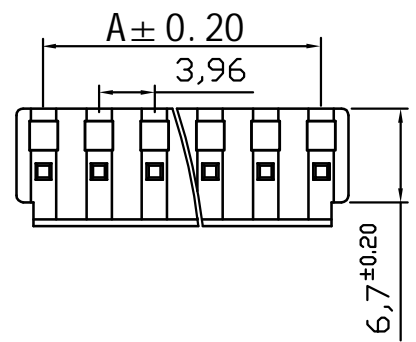

| PIN | 尺寸 (mm) | |
|-----|---------|-------|
| | A | B |
| 2P | 3.96 | 7.92 |
| 3P | 7.92 | 11.88 |
| 4P | 11.88 | 15.84 |
| 5P | 15.84 | 19.80 |
| 6P | 19.80 | 23.76 |
| 7P | 23.76 | 27.72 |
| 8P | 27.72 | 31.68 |
| 9P | 31.68 | 35.64 |
| 10P | 35.64 | 39.60 |
| 11P | 39.60 | 43.56 |
| 12P | 43.56 | 47.52 |
| 13P | 47.52 | 51.48 |
| 14P | 51.48 | 55.44 |
| 15P | 55.44 | 59.40 |
| 16P | 59.40 | 63.36 |

技术要求

1. 温度范围 (Temperature range): $-25^{\circ}C \sim +85^{\circ}C$
2. 额定电压 (Voltage rating): 250V.AC/DV
3. 额定电流 (Current rating): 7.5A
4. 接触电阻 (Contact resistance): $\leq 0.02 \Omega$
5. 绝缘电阻 (Insulation resistance): $\geq 1000M \Omega$
6. 耐压 (Withstand voltage): 1000V.AC/1分钟 (Minute)

深圳市华德共创科技有限公司
Shenzhen Huade co-create Technology Co., LTD
TEL: 0755-27129737 FAX: 0755-29940187

| | | | | | | |
|---|-------|--------|--------------------------|-------------------|---------------------------------|-------|
| -TOLERANCES- UNLESS OTHERWISE SPECIFIED 公差参数表 | | | TITLE: 产品名称: VH3.96直针 | | | |
| X.X | ±0.30 | X.X° | ±3° | APPD: 核准: 谢亮 | PART NO: 产品编号: HDGC3963WV-XP | |
| X.XX | ±0.30 | X.XX° | ±2° | CHECK: 校对: 王建业 | DATE | SCALE |
| X.XXX | ±0.10 | X.XXX° | ±1° | DRAW: 绘图: 黄艳兰 | 2013-06-11 | 1:1 |
| | | | | UNIT | CODE NUMBER | |
| | | | | mm | A126 | |