



## Heyco® Latches and Strikers

### Latches

| MOUNTING HOLE SIZE                                    |             | PANEL THICKNESS |           | PART NO. | DESCRIPTION | PART DIMENSIONS |      |             |      |            |      | STRIKER Part No. |
|-------------------------------------------------------|-------------|-----------------|-----------|----------|-------------|-----------------|------|-------------|------|------------|------|------------------|
| in.                                                   | mm.         | in.             | mm.       |          |             | A Length        |      | B Head Dia. |      | C Head Ht. |      |                  |
|                                                       |             |                 |           | Natural  |             | in.             | mm.  | in.         | mm.  | in.        | mm.  |                  |
| <b>Round Mounting Hole Latch</b>                      |             |                 |           |          |             |                 |      |             |      |            |      |                  |
| .354                                                  | 9,0         | .05 - .06       | 1,2 - 1,6 | 14300    | DL-10F-N2W  | .33             | 8,5  | .43         | 10,8 | .10        | 2,5  | 14304            |
| <b>Rectangular and Compound Mounting Hole Latches</b> |             |                 |           |          |             |                 |      |             |      |            |      |                  |
| see schematic                                         |             |                 |           | 14301    | DL-009-POW  | 1.49            | 37,8 | .51         | 13,0 | .48        | 12,1 | 14305            |
| .465 x .665                                           | 11,8 X 16,9 | .04             | 1,0       | 14302    | DL-20-W     | .79             | 20,0 | .73         | 18,5 | .59        | 14,9 | 14306            |

- Latches and Strikers assemble together to keep a panel closed tightly.
- Design ensures an easy release when needed.

Standard color natural.

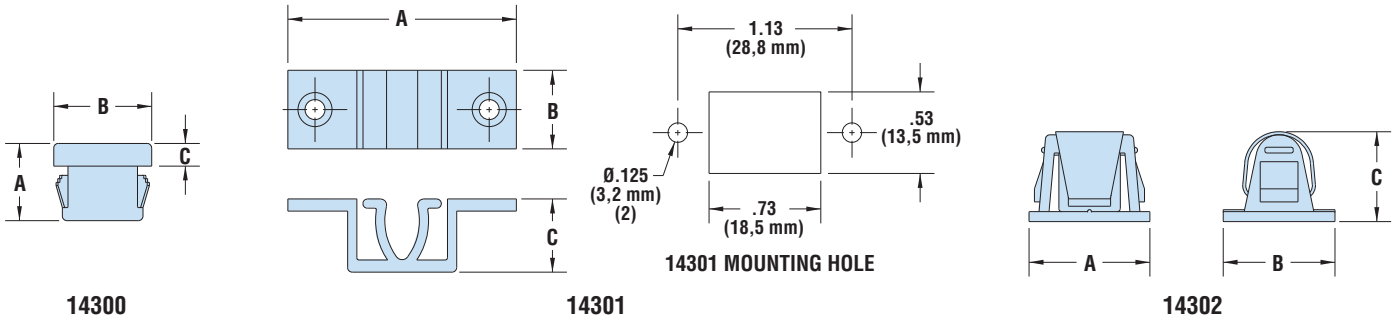

### Strikers

| MOUNTING HOLE(s) Diameter |           | Separation |      | PART NO. | DESCRIPTION | PART DIMENSIONS |      |             |      |          |      | Use with Latch Part No. |
|---------------------------|-----------|------------|------|----------|-------------|-----------------|------|-------------|------|----------|------|-------------------------|
| in.                       | mm.       | in.        | mm.  |          |             | A Length        |      | B Head Dia. |      | C Height |      |                         |
|                           |           |            |      | Natural  |             | in.             | mm.  | in.         | mm.  | in.      | mm.  |                         |
| .122                      | 3,1       | .63        | 15,9 | 14304    | DLS-10A-W   | 1.02            | 26,0 | .59         | 15,0 | .47      | 12,0 | 14300                   |
| .125                      | 3,2       | .71        | 18,0 | 14305    | DLS-008-N2W | 1.02            | 25,8 | .51         | 13,0 | .45      | 11,4 | 14301                   |
| .283 x .335               | 7,2 x 8,5 | n/a        |      | 14306    | DLS-20A-WA  | .43             | 10,8 | .43         | 11,0 | .81      | 20,6 | 14302                   |

Standard color natural.

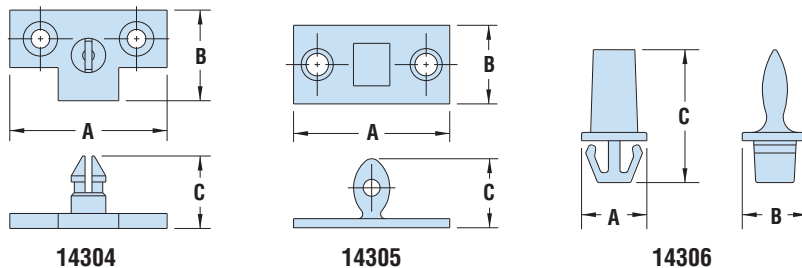

Material: Nylon 6/6  
 Flammability Rating: 94V-2  
 Temperature Range: 32°F (0°C) to 185°F (85°C)

Quick Specs

# Mouser Electronics

Authorized Distributor

Click to View Pricing, Inventory, Delivery & Lifecycle Information:

[Heyco:](#)

[14301](#) [14302](#) [14305](#) [14306](#) [14304](#) [14300](#)