

# C-SCFI 1,5/2,8X0,5 - Connector

3240048

<https://www.phoenixcontact.com/us/products/3240048>

Please be informed that the data shown in this PDF document is generated from our online catalog. Please find the complete data in the user documentation. Our general terms of use for downloads are valid.



Slip-on sleeve, red, 0.5 ... 1.5 mm<sup>2</sup>, 2.8 x 0.5

## Your advantages

- "Easy Entry" for easy and reliable conductor entry
- Halogen-free
- Hard-soldered crimping zone for maximum pull-out forces
- Electrogalvanized

## Commercial data

Item number	3240048
Packing unit	100 pc
Minimum order quantity	100 pc
Sales key	BH34
Product key	BH3451
Catalog page	Page 499 (C-3-2019)
GTIN	4046356452663
Weight per piece (including packing)	0.646 g
Weight per piece (excluding packing)	0.646 g
Customs tariff number	85366990
Country of origin	CN

# C-SCFI 1,5/2,8X0,5 - Connector

3240048

<https://www.phoenixcontact.com/us/products/3240048>

## Technical data

### Product properties

Product type	Connector
--------------	-----------

### Electrical properties

Fuse	yes
------	-----

### Dimensions

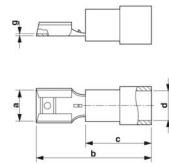
Dimensional drawing	
Width	2.8 mm
Length of the insulating material sleeve	10.5 mm
Maximum stripping length	7 mm
Min. material thickness	0.25 mm
Inner dimensions of the insulating collar	4.1 mm

### Material specifications

Color	red
Material	Brass
Flammability rating according to UL 94	V2
Coating	tin-plated
Insulating material	PA
Components	halogen-free

### Environmental and real-life conditions

#### Ambient conditions

Ambient temperature (operation)	-20 °C ... 105 °C
---------------------------------	-------------------

# C-SCFI 1,5/2,8X0,5 - Connector

3240048

<https://www.phoenixcontact.com/us/products/3240048>



## Drawings

Dimensional drawing

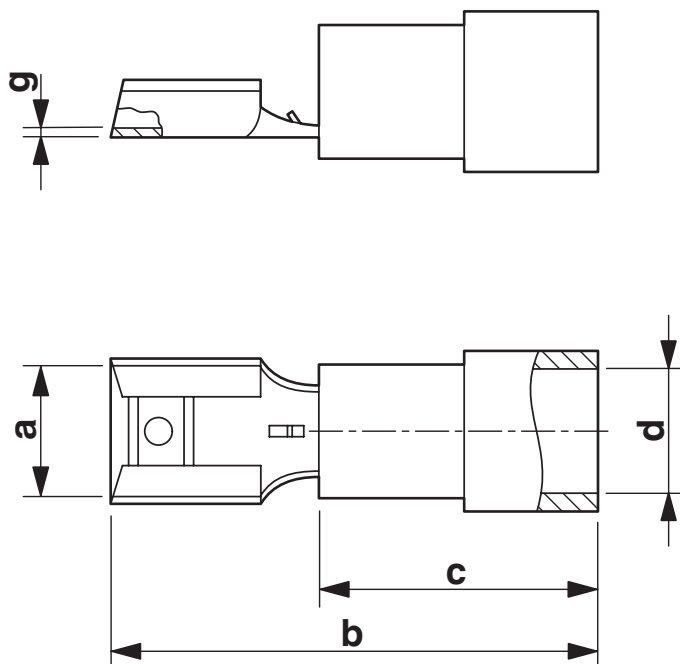

# C-SCFI 1,5/2,8X0,5 - Connector



3240048

<https://www.phoenixcontact.com/us/products/3240048>

## Classifications

### ECLASS

ECLASS-11.0	27400204
ECLASS-12.0	27400204
ECLASS-13.0	27400204

### ETIM

ETIM 9.0	EC001052
----------	----------

### UNSPSC

UNSPSC 21.0	27121700
-------------	----------

# C-SCFI 1,5/2,8X0,5 - Connector



3240048

<https://www.phoenixcontact.com/us/products/3240048>

## Environmental product compliance

### EU RoHS

Fulfills EU RoHS substance requirements	Yes, No exemptions
---	--------------------

### China RoHS

Environment friendly use period (EFUP)	EFUP-E
	No hazardous substances above the limits

### EU REACH SVHC

REACH candidate substance (CAS No.)	No substance above 0.1 wt%
-------------------------------------	----------------------------

# C-SCFI 1,5/2,8X0,5 - Connector

3240048

<https://www.phoenixcontact.com/us/products/3240048>



## Accessories

### CRIMPFOX-RCI 2,5-M - Crimping pliers

1212728

<https://www.phoenixcontact.com/us/products/1212728>



**Crimping pliers**, compact pliers, for insulated cable lugs (red, blue), two marked die stations, unlockable pressure lock, lateral entry

---

### CRIMPFOX-RCI 6-1 - Crimping pliers

1212059

<https://www.phoenixcontact.com/us/products/1212059>



Crimping pliers, for insulated cable lugs, 0.5 mm<sup>2</sup> ... 6.0 mm<sup>2</sup> (red, blue, yellow), oval crimp, asymmetrical

# C-SCFI 1,5/2,8X0,5 - Connector

3240048

<https://www.phoenixcontact.com/us/products/3240048>



## CF 500/DIE RCI 1,5 - Crimp insert

1212263

<https://www.phoenixcontact.com/us/products/1212263>



Die for CF 500 automatic crimping device, for insulated cable lugs (C-RCI... and C-FCI...) 0.14 mm<sup>2</sup> ... 1.5 mm<sup>2</sup>

---

Phoenix Contact 2024 © - all rights reserved

<https://www.phoenixcontact.com>

Phoenix Contact USA  
586 Fulling Mill Road  
Middletown, PA 17057, United States  
(+717) 944-1300  
[info@phoenixcon.com](mailto:info@phoenixcon.com)