

NOTES1:

- UL Standard
- Rated voltage/current : 150V / 4A
- Withstanding voltage : AC1250V/1Min.
- Insulation Resistance:1000MΩ Min
- Contact Resistance:20mΩ Max

IEC Standard

1. Pollution degree	2	2	3
Overvoltage category	II	III	III
Rate impulse voltage(kV)	2.5kV	2.5kV	2.5kV
Rate voltage(V)	320V	250V	160V
Rate current(A)	5A		

NOTES2:

- 1.Dimension shall be interpreted per ASME Y14.5-2009
- 2.Pitch : 2.50mm, Poles : N=02~24P
- 3.Operating temperature: -40°C~+105°C
- 4.Undimensioned tolerances:

Pitch range in mm		Nominal dimension range				mm	
Over	TO	Over	TO	Over	TO	Over	TO
6	10	30	60	100	150	0.1/10	
10	24	30	60	100	150	<	
		±0.15±0.20		±0.30±0.50±0.70±1.00±1.30		±2'	

5.RoHS Compliance

# Ordering Information

**JL15EDGRC-250 XX G 02**

Pitch 250=2.50PH  
 No.of pins 2P~24P  
 Housing Color  
 B=Black  
 G=Green  
 U=Blue  
 R=Red  
 W=White  
 Y=Yellow  
 O=Orange  
 E=Grey  
 Packing  
 0=Pe bag  
 T=Tube  
 A=Troy

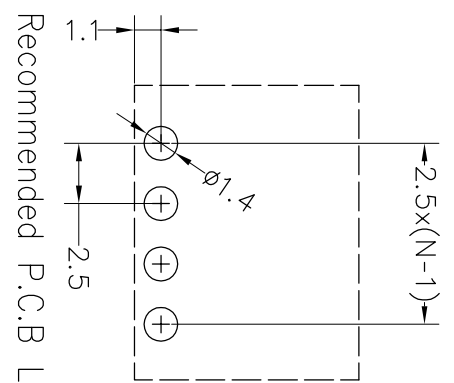

Recommended P.C.B Layout(Top Side) **02P**

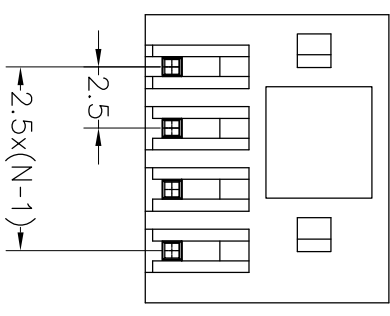
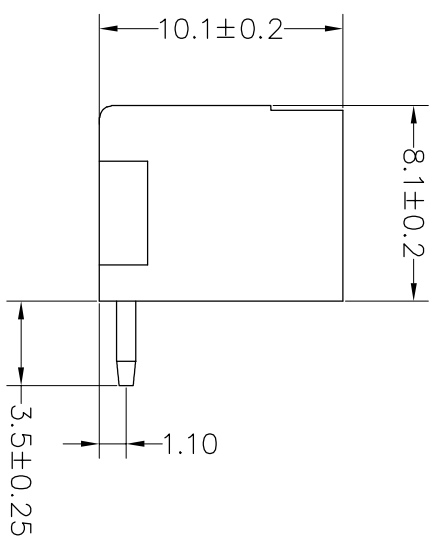
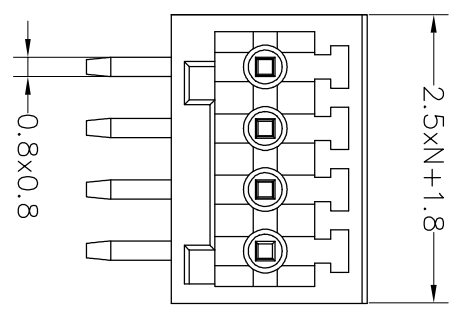
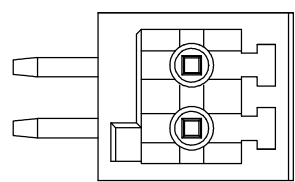

REVISION RECORD				
REV	ECN	DESCRIPTION	DRFT	DATE
A0		NEW		21.11.5

DRAW	SHUANGPING ZHENG		SCALE	FIT	PART NO.	TITLE:
	CHECK	LICHAO LIU	UNIT	mm		
APPROVE	YONGLANG GAO		SIZE	A4	JL15EDGRC-250XXG02	JL15EDGRC-2.50-XXP插拔式公座/弯脚/绿色
			SHEET	1/1		
			PROJ.			

**JILIN** 东莞市锦凌电子有限公司  
 DONGGUAN JINLING ELECTRONIC CO., LTD