

Discription

The LESD8D5.0CA is designed to protect voltage sensitive components from ESD. Excellent clamping capability, low leakage, and fast response time, make these parts ideal for ESD protection on designs where board space is at a premium.

Because of its small size, it is suited for use in cellular phones, MP3 players, digital cameras and many other portable applications where board space is at a premium.

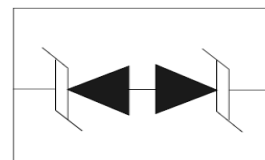

Features

- Low Leakage
- Response Time is Typically < 1 ns
- ESD Rating of Class 3 (> 16 kV) per Human Body Model
- IEC61000-4-2 Level 4 ESD Protection
- These are Pb-Free Devices
- We declare that the material of product compliance with RoHS requirements.

Applications

- Cellular phones
- audio MP3 players
- Digital cameras
- Portable
- applications mobile telephone

MAXIMUM RATINGS

| Rating | Symbol | Value | Unit |
|---|----------------------------------|------------|----------|
| IEC 61000-4-2 (ESD) Air discharge Contact discharge | | ±25 ±20 | kV kV |
| Total Power Dissipation on FR-5 Board (Note 1) @ T _A =25 °C | PD | 200 | mW |
| Junction and Storage Temperature Range | T _J ,T _{STG} | -55 to 150 | °C |
| Lead Solder Temperature – Maximum (10 Second Duration) | TL | 260 | °C |

Stresses exceeding Maximum Ratings may damage the device. Maximum Rating are stress ratings only. Functional operation above the Recommended Operating Conditions is not implied. Extended exposure to stresses above the Recommended Operating Conditions may affect device reliability.

1. FR-5 = 1.0*0.75*0.62 in.

ELECTRICAL CHARACTERISTICS

| Device | V_{RWM} (V) | I_{R1} (μ A) @ V_{RWM} | I_{R2} (μ A) @ $V_R=3.5V$ | V_{BR} (V) @ I_T (Note 2) | | I_T mA | V_C (V) @ $I_{PP} = 1$ A (Note 3) | V_C (V) @ MAX I_{PP} (Note 3) | I_{PP} (A) (Note 3) | P_{PK} (W) (Note 3) | C (pF) |
|-------------|------------------|------------------------------------|-------------------------------------|----------------------------------|-----|-------------|---|---|--------------------------|--------------------------|--------|
| | Max | Max | Max | Min | Max | | Max | Max | | | |
| LESD8D5.0CA | 5.0 | 0.5 | 0.3 | 5.6 | 8.0 | 1.0 | 9.8 | 12.5 | 5.5 | 69 | 15 |

Other voltage available upon request.

- V_{BR} is measured with a pulse test current I_T at an ambient temperature of 25°C
- Surge current waveform per Figure 3.

ELECTRICAL CHARACTERISTICS

($T_A = 25^\circ C$ unless otherwise noted)

| Symbol | Parameter |
|-----------|---|
| I_{PP} | Maximum Reverse Peak Pulse Current |
| V_C | Clamping Voltage @ I_{PP} |
| V_{RWM} | Working Peak Reverse Voltage |
| I_R | Maximum Reverse Leakage Current @ V_{RWM} |
| V_{BR} | Breakdown Voltage @ I_T |
| I_T | Test Current |
| P_{pk} | Peak Power Dissipation |
| C | Capacitance @ $V_R = 0$ and $f = 1.0$ MHz |

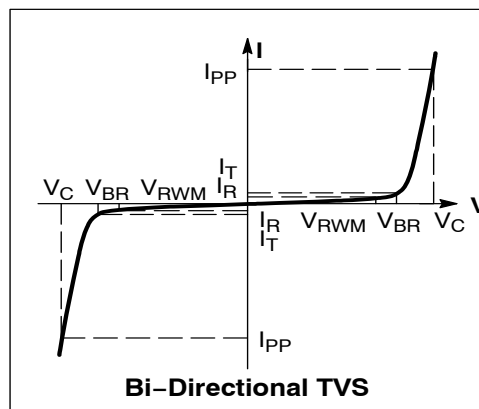

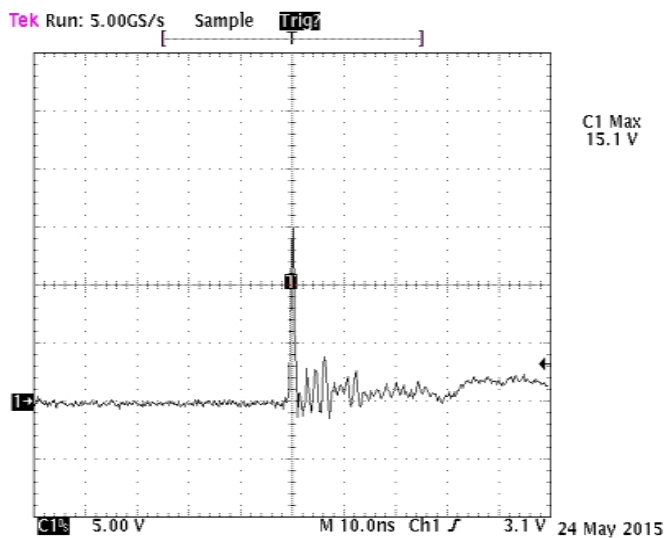

Fig1. ESD Clamping Voltage Screenshot Positive 8 kV Contact per IEC61000-4-2

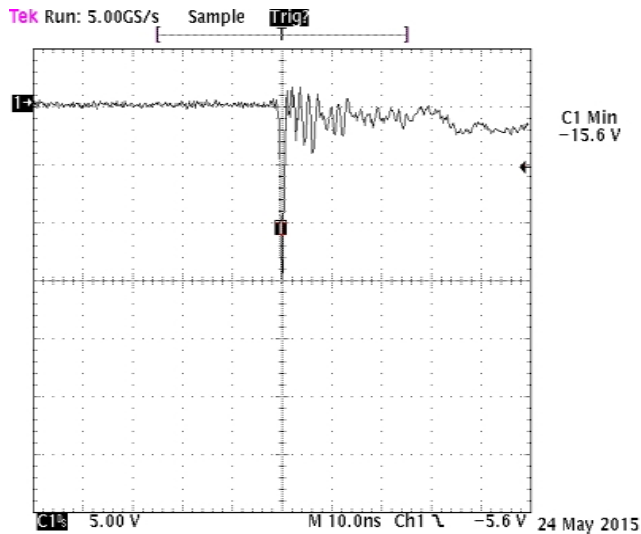

Fig2. ESD Clamping Voltage Screenshot Negative 8 kV Contact per IEC61000-4-2

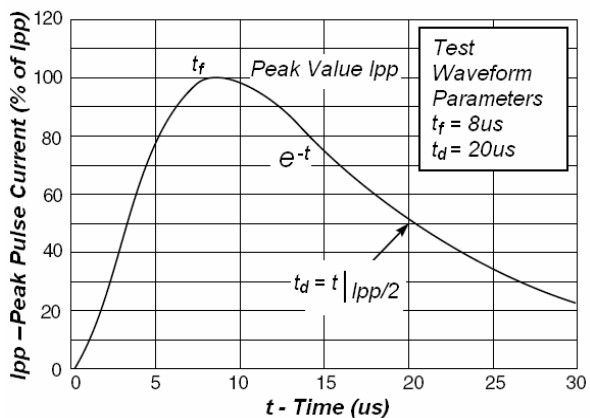
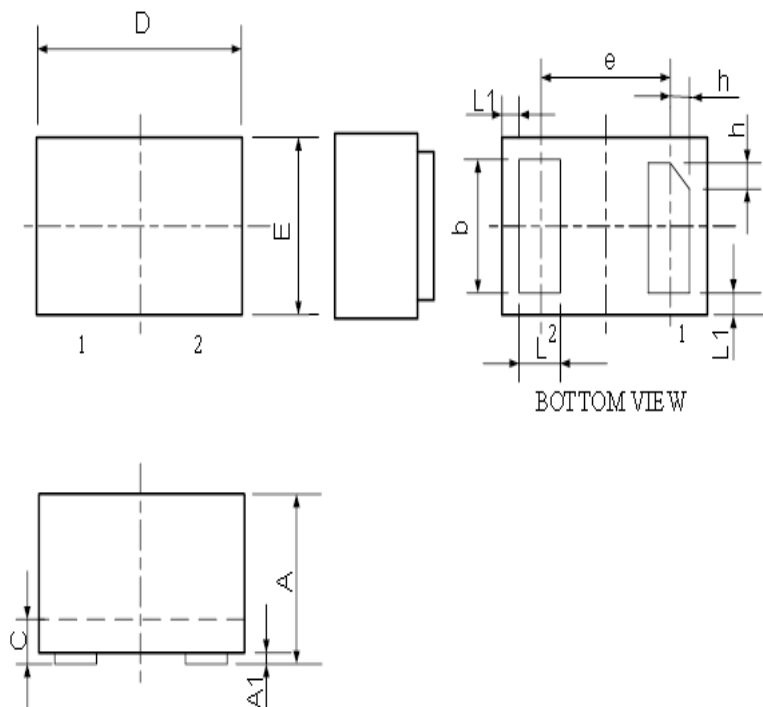

Fig3. Pulse Waveform

SOD-882 PACKAGE OUTLINE DIMENSIONS



| Symbol | Dimensions In Millimeters | |
|--------|---------------------------|---------|
| | Minimum | Maximum |
| A | 0.450 | 0.550 |
| A1 | 0.000 | 0.050 |
| b | 0.45 | 0.55 |
| C | 0.12 | 0.18 |
| D | 0.950 | 1.050 |
| e | 0.65BSC | |
| E | 0.550 | 0.650 |
| L | 0.200 | 0.300 |
| L1 | 0.05REF | |
| h | 0.07 | 0.17 |

Marking



Ordering information

| Order code | Package | Baseqty | Deliverymode |
|--------------------|---------|---------|---------------|
| UMW LESD8D5.0CAT5G | SOD-882 | 10000 | Tape and reel |