

D-ST

Screw Termination D'Sub series

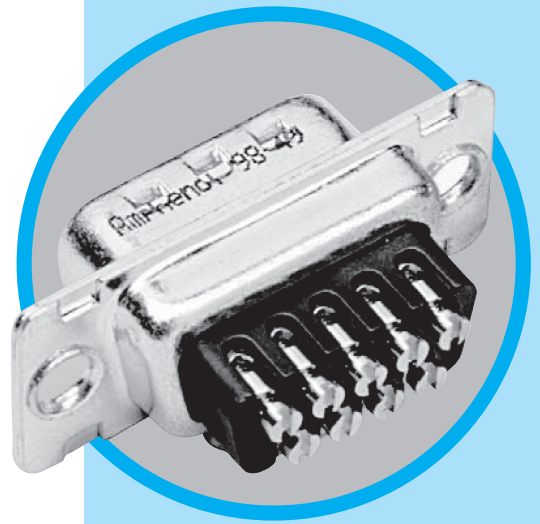

CHARACTERISTICS

- Connectors according to: MIL C24308 - NFC 93425-HE5

Materials and platings	
Shells	Steel, Tin plated
Insulator	Glass filled thermoplastic, UL 94V-0
Contacts	Machined brass for plug full gold Machined bronze for socket, full gold

Electrical Data	
Current rating	7,5 A max
Voltage rating	300 V RMS at 50 Hz
Withstanding voltage	1000 V RMS at 50 Hz
Insulation resistance	> 5000 MΩ at 500 V DC
Contact resistance	< 5 mΩ

Climatic Data	
Operating temperature	- 55°C to + 85°C, peak at 125°C
Damp heat	21 days (40°C - 95% HR)
Salt spray	48 hours

Mechanical Data	
Cable type	Solid or stranded
Cable gage	0.75 mm max (AWG 18) - For bigger wire, please consult factory
Screw torque	0.05 mN max
Mating cycles	100 (class II) or 500 (class I)

DESCRIPTION

The Amphenol Screw Termination D'Sub series is especially designed for field applications.

These new connectors permit easy wiring without any specific tool : Just a standard electrician's screwdriver is required.

Due to their reduced overall dimensions, these connectors are compatible with all standard hoods and accessories

*Simplify
Your cable
assemblies!*

APPLICATIONS

- Industry control of speed variators,
- Houses and public buildings control of heating, air conditioning, lighting, shutters, fire safety...
- Infrastructures fluids control, motorway



Amphenol

D-ST / E3

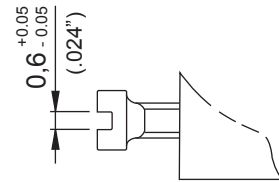
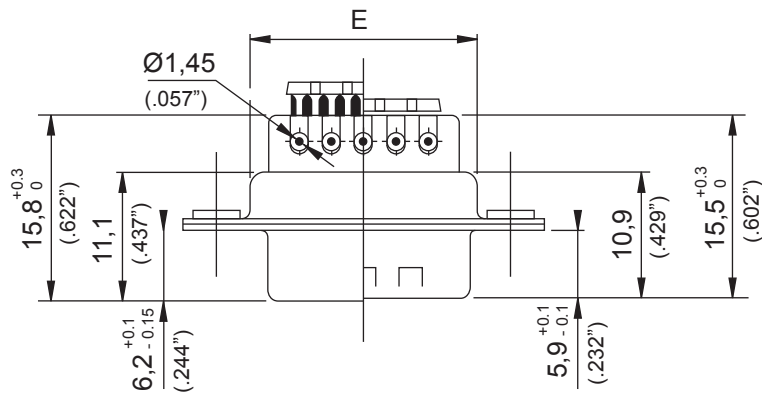
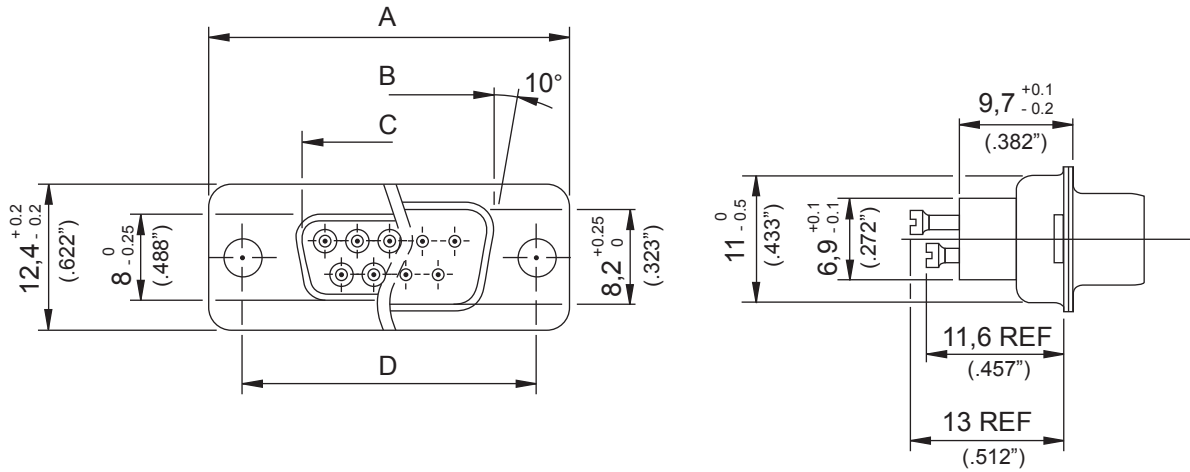

Cable stripping

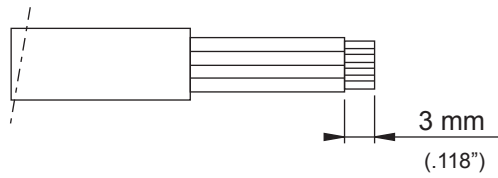

SIZE	A +0,25 (.010") -0,25 (.010")	B 0 -0,2 (.008")	C +0,2 (.008") 0	D +0,1 (.004") -0,1 (.004")	E +0,1 (.004") -0,4 (.016")
9	30.7 (1.209")	16.4 (.646")	16.8 (.661")	25 (.984")	19.4 (.370")
15	39 (1.535")	24.8 (.976")	25.1 (.988")	33.3 (1.311")	27.7 (1.091")
25	52.9 (2.083")	38.5 (1.516")	38.8 (1.528")	47 (1.850")	41.4 (1.630")
37	69.2 (2.724")	54.9 (2.161")	55.3 (2.177")	63.5 (2.500")	57.9 (2.280")

How to order

		L	717D	E09	P	ST	1
		RoHS Compliant					
Class II:	77D	Female connector					
	717D	Male connector, shells with dimples					
Class I:	177D	Female connector					
	777D	Male connector, shells with dimples					
Size and number of contacts		E09, A15, B25, C37					
Type of contact:		P = Male		S = Female			
Contact termination:		ST = Screw termination					
Kit connector + hood option: (See following description)		1 = DPPK hood 2 = DSSK hood 3 = DTZK hood 4 = DVZK hood					

Plastic hoods



DPPK Straight cable entry

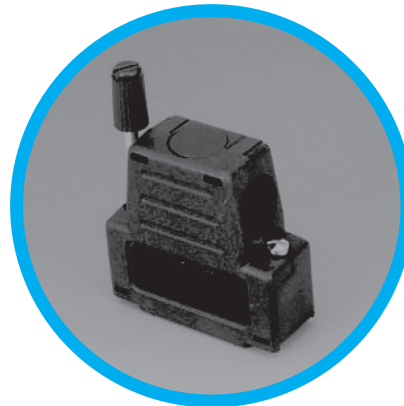

DSSK Angled cable entry

Metallic hoods



DTZK Straight cable entry

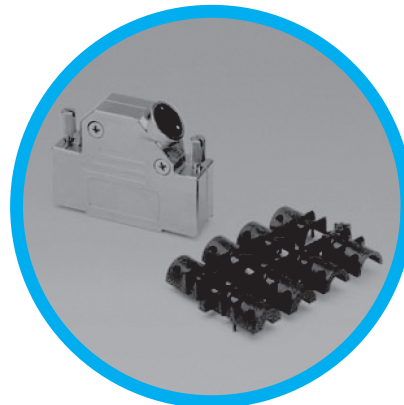

DVZK Angled cable entry

