

PRODUCT NUMBER

XXXXX-YYYHTLF

- LEAD FREE OPTION
SEE NOTE 1,11
- TUBE PACKAGING OPTION
SEE NOTE 1
- HIGH TEMPERATURE PLASTIC
SEE NOTE 1
- NO. OF POSITIONS
SEE NOTE 1
- PIN PLATING
SEE SHEET 2
- BASE PART NO.

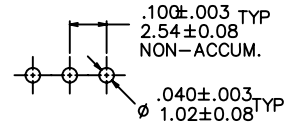
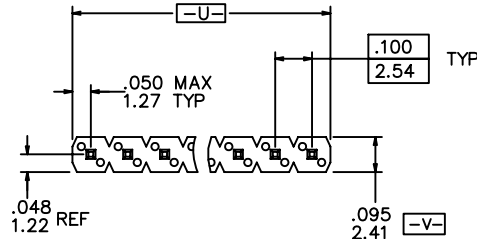

RECOMMENDED HOLE PATTERN

PRODUCT NUMBER

69190-XXXXXHALF

- LEAD FREE OPTION
SEE NOTE 1,11
- PACKAGING OPTION
SEE NOTE 1
- HIGH TEMPERATURE PLASTIC
SEE NOTE 1
- INDICATE DIFFERENT MATING LENGTH
AND TAIL LENGTH
- NO. OF POSITIONS
SEE NOTE 1
- PIN PLATING
SEE SHEET 2
- BASE PART NO.

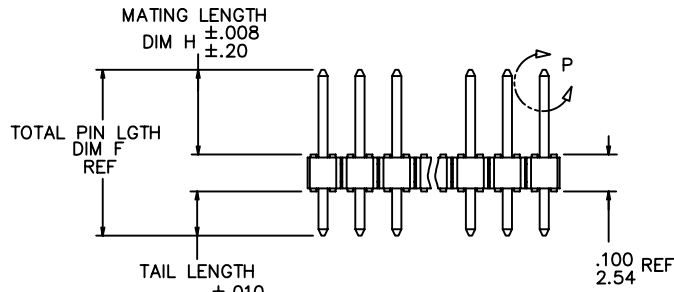

SIDE VIEW

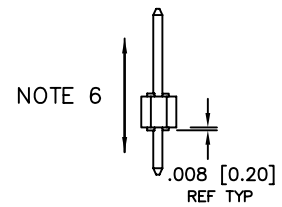

END VIEW

⊕ ∅ .020/.51 (M) U (M) V (S)

NOTE 4

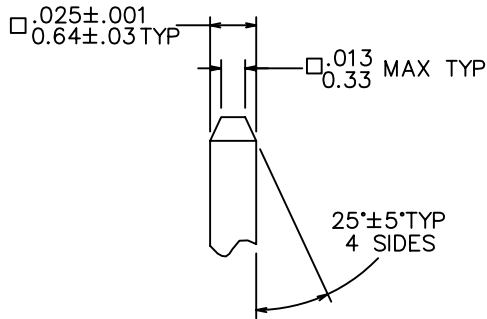

DETAIL P
TYP BOTH ENDS

| | | | | | | | | | |
|-------------|-------------|------------|------------|---------------------------------------|--------------|------------|--|-------------------------------|--|
| mat'l. code | | surface | | tolerance | | projection | | product family | |
| NOTES 2 & 3 | | ISO 1302 ✓ | | ISO 406 ISO 1101 | | INCH/MM | | BERGSTIK | |
| ltr | ecn | nldr | date | tolerances unless otherwise specified | | scale 1:1 | | title | |
| AM | ELX-N-13674 | DCS | 2012-12-12 | angles | linear | | | BERGSTIK® II HEADER | |
| AN | ELX-N-16105 | ZK | 2013-10-22 | | | | | .100/2.54 SR SELF-RET | |
| AP | ELX-N-19414 | HJ | 2014-11-13 | 0°±2' | | | | dwg no | |
| | | | | dr | D. WHITING | 4/19/93 | | sheet 1 of 4 | |
| AJ | M06-0346 | MHT | 9/04/06 | engr | T.HANNA | 4/19/93 | | 69190 | |
| AK | M08-0291 | MHT | 10/06/08 | chr | T. BREWBAKER | 4/19/93 | | A3 | |
| AL | N11-0118 | J.Z | 2011-04-11 | appd | T.HANNA | 4/19/93 | | type Product Customer Drawing | |
| sheet | revision | AP | | | | | | | |
| index | sheet | 1-4 | | | | | | | |



FCIconnect.com

Copyright FCI

PIN PLATING CODES:

| | |
|-------------|---|
| XXXX-1YY | 30u"/0.76u MIN (SEE NOTE 12) OVER 50u"/1.27u MIN Ni |
| XXXX-2YY | 15u"/0.38u MIN (SEE NOTE 12) OVER 50u"/1.27u MIN Ni |
| XXXX-3YY | 50u"/1.27u MIN (SEE NOTE 12) OVER 50u"/1.27u MIN Ni |
| XXXX-4YY | 100u"/2.54u MIN Sn OVER 50u"/1.27u MIN Ni (SEE NOTE 13) |
| XXXX-4YYHLF | |
| XXXX-5YY | 15u"/0.38u MIN (SEE NOTE 12) OVER 50u"/1.27u MIN Ni |
| XXXX-6YY | 30u"/0.76u MIN (SEE NOTE 12) OVER 50u"/1.27u MIN Ni |
| XXXX-7YY | 30u"/0.76u MIN (SEE NOTE 12) OVER 50u"/1.27u MIN Ni |
| XXXX-8YY | 15u"/0.38u MIN (SEE NOTE 12) OVER 50u"/1.27u MIN Ni |
| XXXX-9YY | 15u"/0.38u MIN (SEE NOTE 12) OVER 50u"/1.27u MIN Ni |
| XXXX-0YY | 30u"/0.76u MIN (SEE NOTE 12) OVER 50u"/1.27u MIN Ni |

NOTES

1. PART NUMBER OPTIONS:

PIN PLATING CODES (SEE ABOVE)

HIGH TEMP. MATERIAL:

FOR HIGH-TEMPERATURE APPLICATIONS, SPECIFY AN "H" AT THE END OF THE PART NUMBER, AND PCT WILL BE SUPPLIED.

NUMBER OF POSITION:

ANY NUMBER OF POSITIONS FROM 2 THRU 36.

PACKAGING:

PACKAGED IN POLY BAGS.

EIGHT DIGIT PART NUMBERS FOLLOWED BY A "T" ARE PACKAGED IN TUBES. SEE SPECIFIC PART NUMBERS FOR AVAILABILITY.

EIGHT DIGIT PART NUMBERS FOLLOWED BY A "A" ARE PACKAGED IN TAPE AND REEL WITH PICKUP CAPS.

LEAD FREE:

ADD "HLF" SUFFIX AT THE END OF PART NUMBER FOR LEAD FREE OPTION, NOT AVAILABLE FOR -5YY,-5YYH,-6YY & -6YYH.

2. BODY MATERIAL:

MANUFACTURER'S OPTION OF NYLON OR PCT, GLASS FIBER REINFORCED, FLAME RETARDENT PER UL-94V-0.

COLOR: BLACK. OR MINERAL FILLED LCP, COLOR BLACK FLAME RETARDENT PER UL-94V-0.

PART NUMBERS WITH "H" SUFFIX WILL WITHSTAND EXPOSURE TO 260° PEAK TEMPERATURE FOR 20 SECONDS IN WAVE SOLDER, INFRA-RED OR VAPOR PHASE SOLDER PROCESS.

PART NUMBERS WITHOUT "H" SUFFIX WILL WITHSTAND EXPOSURE TO 260° PEAK TEMPERATURE FOR WAVE SOLDER PROCESS.

3. PIN MATERIAL: PHOS-BRONZE.

4. MEASURED WITH PART IN RESTRAINED CONDITION.

5. TWO SIDES OF PIN TIPS NOT PLATED. TYPICAL BOTH ENDS.

6. 2LBS/0.9KG MIN PIN RETENTION IN EITHER DIRECTION.

7. ±.010/0.25 TOL APPLIES TO ALL 'G' TAILS EXCEPT INDICATED PARTS ON TABLE WHERE +.010/0.25 -.000/0.00 APPLIES.

8. DETAIL N DIMENSIONS APPLY TO 2 POSITION PARTS ONLY

9. SECTION R-R DIMENSIONS ONLY APPLY TO RETENTION. PIN POSITIONS FOR 3 POSITION PARTS AND LARGER. RETENTION PIN POSITIONS LOCATED AT MANUFACTURER'S OPTION.

10. 5LB/2.3KG MAX INSERTION FORCE AND .25LB/.1KG MIN RETENTION FORCE PER RETENTIVE PIN USING .062/1.57 THICK CIRCUIT BOARDS AND RECOMMENDED HOLE PATTERN.

11. THESE PRODUCTS MEETS EUROPEAN UNION DIRECTIVES AND OTHER COUNTRY REGULATION AS DESCRIBED IN GS-22-008.

12. PLATING OPTIONS:
PERFORMANCE PLATING WILL BE EITHER GOLD OR GXT ON POST OR TAIL, OPTIONALLY (78~295u"/2~7.5u) TIN ON TAIL.

13."THIS PRODUCT HAS 100% TIN PLATING IN THE INTERFACE AND HAS NOT BEEN TESTED FOR WHISKER GROWTH IN ALL INTERCONNECT ENVIRONMENTS."

| | | | | | | | | | |
|-------------|-----|--|----|--|--------|----------------|-----------|----------------------------|---|
| mat'l. code | | surface ISO 1302 ✓ ISO 406 ISO 1101 | | tolerance tolerances unless otherwise specified | | projection | | product family BERGSTIK | |
| ltr | ecn | no | dr | date | angles | linear | INCH/MM | | title |
| AP | | | | | | | scale 1:1 | | BERGSTIK II HEADER .100/2.54 SR SELF-RET |
| | | | | | 0±2° | | | | dwg no |
| | | | | | dr | D. WHITING | 4/19/93 | | sheet 2 of 4 |
| | | | | | enr | T.HANNA | 4/19/93 | | size |
| | | | | | chr | T. BREWBAKER | 4/19/93 | | A3 |
| | | | | | app | T.HANNA | 4/19/93 | | type |
| sheet index | | revision sheet | | | | | | Product Customer Drawing | |

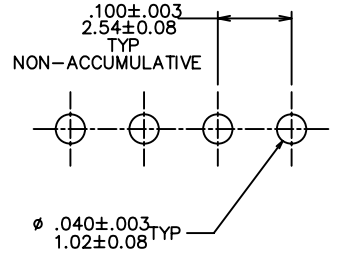

RECOMMENDED HOLE PATTERN

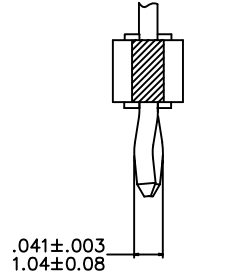

SECTION R-R
NOTE 9

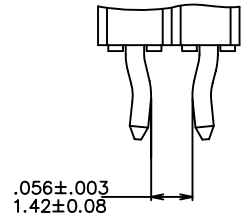
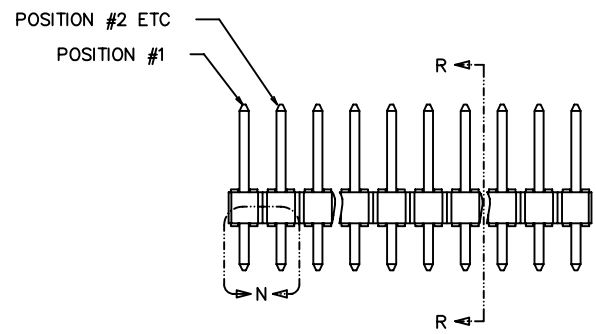

TWO POSITION
DETAIL N
NOTE 8



FCIconnect.com

Copyright FCI

| | | | | | | | | | |
|-------------|----------|-----------------------|----|----------------------------------|--|---------------------------------------|--------------|---|--|
| mat'l. code | | surface ISO 1302 ✓ | | tolerance ISO 406 ISO 1101 | | projection INCH/MM | | product family BERGSTIK | |
| ltr | ecn | no | dr | date | | tolerances unless otherwise specified | | title | |
| AP | | | | | | angles | linear | BERGSTIK II HEADER .100/2.54 SR SELF-RET | |
| | | | | | | 0°±2' | | scale 1:1 | |
| | | | | | | dr | D. WHITING | 4/19/93 | |
| | | | | | | enr | T.HANNA | 4/19/93 | |
| | | | | | | chr | T. BREWBAKER | 4/19/93 | |
| | | | | | | app | T.HANNA | 4/19/93 | |
| sheet | revision | | | | | | | | |
| index | sheet | | | | | | | | |



| PRODUCT NUMBER | TOTAL PIN LENGTH | | TAIL LENGTH | | MATING LENGTH | | PACKAGING | NOTE | LF OPTION |
|-----------------------|------------------|------------------|------------------|-----------------|------------------|------------------|----------------------------|--------------|---------------------------|
| | DIM F | DIM F | DIM G | DIM G | DIM H | DIM H | | | |
| | ENGLISH | METRIC | ENGLISH | METRIC | ENGLISH | METRIC | | | |
| 69190-YYY | 0.450 | 11.43 | 0.120 | 3.05 | 0.230 | 5.84 | POLY BAGS/TUBES | - | NOTE 1,11 ↑ OB ↓ |
| 72348-YYYH | 0.515 | 13.08 | 0.120 | 3.05 | 0.295 | 7.49 | POLY BAGS | - | |
| 78229-YYY | 0.538 | 13.67 | 0.120 | 3.05 | 0.318 | 8.08 | POLY BAGS/TUBES | - | |
| 78250-YYY | UNAVAILABLE | | | | | | | - | |
| 78538-YYY | 0.620 | 15.75 | 0.120 | 3.05 | 0.400 | 10.16 | POLY BAGS | - | |
| 78594-YYY | 0.760 | 19.30 | 0.120 | 3.05 | 0.540 | 13.72 | POLY BAGS | - | |
| 79429-YYY | 0.695 | 17.65 | 0.120 | 3.05 | 0.475 | 12.07 | POLY BAGS | - | |
| 79978-YYY | 0.450 | 11.43 | 0.120 | 3.05 | 0.230 | 5.84 | POLY BAGS/TUBES | 7 | |
| 86505-YYY | 0.440 | 11.18 | 0.120 | 3.05 | 0.220 | 5.59 | POLY BAGS | - | |
| 87036-YYY | 0.830 | 21.08 | 0.120 | 3.05 | 0.610 | 15.49 | POLY BAGS | - | |
| 87068-YYY | 0.530 | 13.46 | 0.115 | 2.92 | 0.315 | 8.00 | POLY BAGS | - | |
| 87280-YYY | 1.000 | 25.40 | 0.120 | 3.05 | 0.780 | 19.81 | POLY BAGS | - | |
| 87452-YYY | 0.840 | 21.34 | 0.120 | 3.05 | 0.620 | 15.75 | POLY BAGS | - | |
| 87453-YYY | 0.990 | 25.15 | 0.120 | 3.05 | 0.770 | 19.56 | POLY BAGS | - | |
| 87918-YYY | 0.730 | 18.54 | 0.120 | 3.05 | 0.510 | 12.95 | POLY BAGS | - | |
| 90603-YYY | 0.430 | 10.92 | 0.100 | 2.54 | 0.230 | 5.84 | POLY BAGS | - | |
| 90610-YYY | 0.927 | 23.55 | 0.100 | 2.54 | 0.727 | 18.47 | POLY BAGS | - | |
| 94549-YYYH | 0.415 | 10.54 | 0.085 | 2.16 | 0.230 | 5.84 | POLY BAGS | - | |
| 69190-XXY001HLF | 0.425 | 10.80 | 0.095 | 2.41 | 0.230 | 5.84 | POLY BAGS | - | |
| 69190-XXY002HLF | 0.378 | 9.59 | 0.120 | 3.05 | 0.157 | 4.00 | POLY BAGS/TUBES | - | |



FCIconnect.com

Copyright FCI

| | | | | | | | | | |
|-------------|--|---|--|--------------|--|------------|--|---|--|
| mat'l. code | | surface <input checked="" type="checkbox"/> ISO 1302 <input type="checkbox"/> ISO 406 <input type="checkbox"/> ISO 1101 | | tolerance | | projection | | product family BERGSTIK | |
| ltr | | ecn no | | dr | | date | | tolerances unless otherwise specified | |
| AP | | | | | | | | angles linear $\frac{.XX\pm.01}{.XX\pm.03}$ $\frac{.XXX\pm.005}{.XXX\pm.013}$ $\frac{.XXXX\pm.0020}{.XXX\pm.0.051}$ | |
| | | | | | | | | INCH/MM | |
| | | | | | | | | scale 1:1 | |
| | | dr | | D. WHITING | | 4/19/93 | | title | |
| | | enr | | T.HANNA | | 4/19/93 | | BERGSTIK II HEADER | |
| | | chr | | T. BREWBAKER | | 4/19/93 | | .100/2.54 SR SELF-RET | |
| | | app | | T.HANNA | | 4/19/93 | | dwg no | |
| | | | | | | | | sheet 4 of 4 | |
| | | | | | | | | 69190 | |
| | | | | | | | | A3 | |
| | | | | | | | | type Product Customer Drawing | |
| sheet index | | revision sheet | | | | | | | |

Mouser Electronics

Authorized Distributor

Click to View Pricing, Inventory, Delivery & Lifecycle Information:

[FCI / Amphenol:](#)

[69190-106](#) [69190-105](#) [69190-107](#) [69190-108](#) [69190-109](#) [69190-111](#) [69190-114](#) [69190-116](#) [69190-120](#) [69190-124](#) [69190-125](#) [69190-130](#) [69190-136](#) [69190-205](#) [69190-206](#) [69190-207](#) [69190-208](#) [69190-212](#) [69190-214](#) [69190-220](#) [69190-230](#) [69190-407](#) [69190-408](#) [69190-416](#) [69190-436](#) [69190-504](#) [69190-506](#) [69190-507](#) [69190-508](#) [69190-509](#) [69190-510](#) [69190-512](#) [69190-514](#) [69190-515H](#) [69190-516](#) [69190-517](#) [69190-520](#) [69190-536](#) [69190-603](#) [69190-604](#) [69190-605](#) [69190-606](#) [69190-607H](#) [69190-608](#) [69190-609](#) [69190-617](#) [69190-625](#) [69190-626H](#) [69190-636](#) [78229-103](#) [78229-103H](#) [78229-136](#) [78229-202](#) [78229-202H](#) [78229-206](#) [78229-408](#) [78229-516](#) [78229-531](#) [78229-625H](#) [78538-204H](#) [78538-208H](#) [78538-220H](#) [78538-403H](#) [78538-405](#) [78538-411](#) [78538-436H](#) [78538-510H](#) [69190-410](#) [69190-405](#) [69190-404](#) [69190-403](#) [69190-402](#) [69190-610](#) [78229-436H](#) [78229-102](#) [69190-203](#) [69190-202](#) [69190-204](#) [69190-236](#) [69190-102](#) [69190-202HLF](#) [79429-102H](#) [79429-136H](#) [69190-210HLF](#) [78229-102H](#) [78229-136HLF](#) [78229-203HLF](#) [78229-206HLF](#) [69190-102H](#) [69190-103H](#) [69190-103HLF](#) [69190-104HLF](#) [69190-105H](#) [69190-105HLF](#) [69190-106HLF](#) [69190-108H](#) [69190-108HLF](#) [69190-109H](#) [69190-109HLF](#) [69190-110HLF](#)