

code-x	H
A	4.3
B	4.8
C	5.0
D	5.3
E	5.5
F	6.0

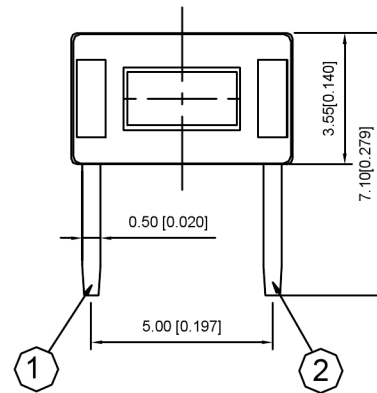

主要技术参数、性能
The Main Thchnology Performance
 额定电流、电压: 50mA DC12V
 Rate voltage,current: 50mA DC12V
 接触电阻: ≤100mΩ
 Contact resistance: ≤100mΩ
 按力: 50gf
 Operating force: 50gf
 行程: 0.20± 0.1 0mm
 Travel: 0.20± 0.1 0mm
 绝缘电阻: ≥100MΩ
 Insulated resistance: ≥100MΩ
 介电强度: ≥250VAC/1min
 Di electric strength: ≥250VAC/1min

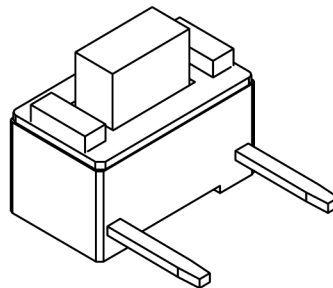
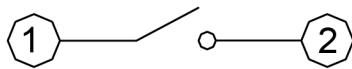

电路图
 CIRCUIT DIAGRAM

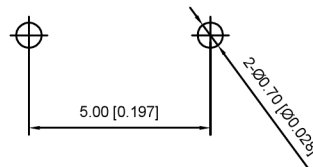

PCB.焊接图
 PCB.WELDING DRAWING

PAPT NO	TC-1101DE-X-X
Operating Force	B:160gf C:260gf
Height	code-x

ITEM	PAPT NAFM	TER.NO	QTY	MATERIAL	FINISHING	REMARK
⑤	Terminal	—	2	Brass (0.30t)	Plating silvering	—
④	Contact	—	1	F.ag/Sus	Natural	—
③	Base	—	1	PPA	—	—
②	Cover	—	1	Spcc	Plating Nickel	—
①	Keystake	—	1	PPA	—	—

广东星坤科技股份有限公司
 日期
 文件工程章

REVISIONS	DATE	REVISED	APPROVED	UNSPECIFIED TOLERANCES
ANGLAR				±5°
L ≤ 4				±0.2
4 < L ≤ 16				±0.3
16 < L ≤ 63				±0.4
L > 63				±0.5



DSND		SCALE: N/A	MODEL TYPE: TACT SWITCH
DWN		VIEW:	PART NO.: TC-1101DE-X-X
CHKD		UNIT: mm/in	DWG NO.:
APPD		SIZE: A4	

XKB INDUSTRIAL PRECISION CO., LIMITED

WEIGHT	SHEET	REVISIC
	1/1	A0