

No. Of Contacts	Dim. A	Dim. B	Dim. C	Dim. D	Dim. E
9	16.92	24.99	30.81	19.28	4.5
15	25.25	33.32	39.14	27.51	
25	38.96	47.04	53.04	41.30	
37	55.42	63.50	69.32	57.71	

铆钉示意图

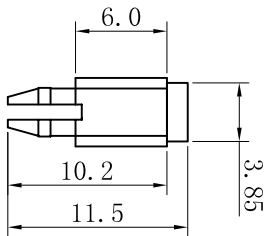

螺丝示意图

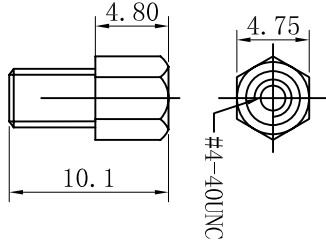

MATERIAL & FINISHES
 INSULATOR - PBT GLASS FIBRE UL94V-0
 CONTACT - BRASS
 SHELL - STEEL
 PLATING - CONTACT
 SELECTIVE GOLD PLATED (CONTACT AREA)
 NICKEL PLATED (TAIL AREA)
 - SHELL
 NICKEL PLATED
 ELECTRICAL CHARACTERISTICS
 CURRENT RATING : 3A
 CONTACT RESISTANCE : < 15mΩ
 INSULATION RESISTANCE : > 3000MΩ
 WITHSTANDING VOLTAGE : 1000V AT 1 MINUTE
 OPERATING TEMPERATURE : -55° C TO +105° C

TOLERANCE TABLE

.0	±0.30
.00	±0.15
.000	±0.05

APPROVED:

DATE:

CHECKED:

DATE:

DRAWN:

DATE:

LYF

2013-9-13

深圳市灿科盟实业有限公司
 Ckmtw CHANKLEMENT INDUSTRYCO., LTD

TITLE:
 DMS-XP 公头 铆鱼叉锁螺丝

CLIENT P/N	/
UNIT	mm
SCALE	free
FILE NO.	Ckmtw-DMS-0003
REV.	A