

# Datasheet

## Right Angle 50Ω PCB Mount BNC Connector, jack, Solder Termination

RS Stock number [526-5858](#)

Dimensions: (mm)

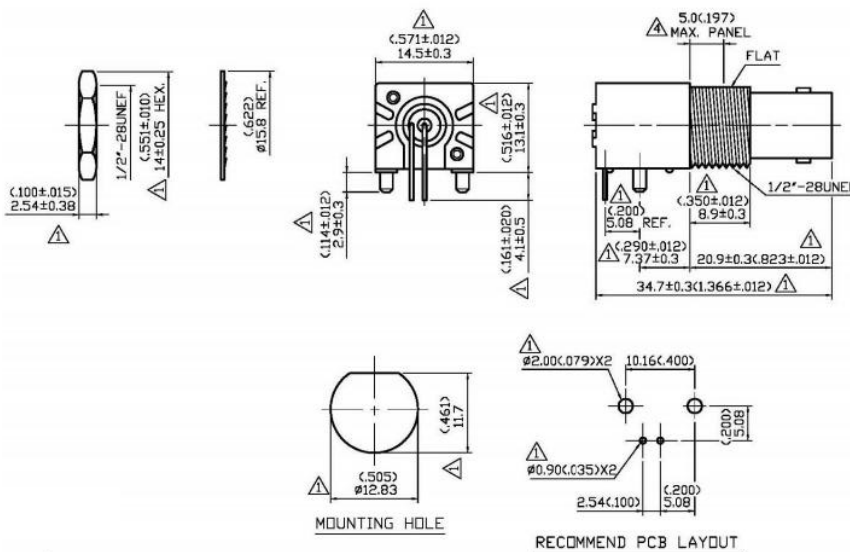

NO	DESCRIPTION	MATERIAL	Q'TY	FINISH
8	LOCK WASHER	S50C	1	NICKEL
7	NUT	BRASS	1	NICKEL
6	CENTER CONTACT	PHOSPHOROUS BRONZE WITH GOLD PLATING AT CONTACT AREA TIN PLATING AT TAIL	1	GOLD TIN
5	INSULATION	POLYPROPYLENE UL 94HB	1	NONE
4	SOLDER PIN	COPPER WIRE	1	TIN
3	BODY	ZINC ALLOY	1	NICKEL
2	HOUSING	PBT+15% G.F (UL 94 V-0)	1	BLACK
1	MOUNTING POST	BRASS	2	TIN

NO	DESCRIPTION	DATE
	2.5 → 2.54±0.38 14.0 HEX. → 14±0.25 HEX. 2.85±0.38 → 2.9±0.3 14.5 REF. → 14.5±0.3 13±0.3 → 13.1±0.3 4±0.38 → 4.1±0.5 7.37±0.38 → 7.37±0.3 8.6 REF. → 8.9±0.3 20.8 REF. → 20.9±0.3 34.8 REF. → 34.7±0.3 Ø2.0X2 → Ø2.00X2 Ø0.9X2 → Ø0.90X2 DEL 6.9 REF. ; ADD 5.08 REF. 12.0 REF. → 11.7 Ø12.9 REF. → Ø12.83 0-4 GHz → 0-1 GHz DEL CONTACT RESISTANCE -55° C TO +85° C → -40° C TO +60° C DEL SALT SPRAY; HUMIDITY MIL-STD-1344,METHOD 1033,COND.A. → MIL-STD-202,METHOD 107,COND.B. MIL-STD-1344,METHOD 2004,COND.G. → MIL-STD-202,METHOD 204,COND.B. BODY → HOUSING MODIFICATION MATERIAL	04.17.09'
	MODIFY APPEARANCE OF Ⓢ	07.01.09'
	ADD MIS PART NO: N13-060-04-0002110AB (P/N5265858)	03.29.11'
	ADD 5.0 MAX. PANEL	02.19.13'

### Specifications

#### Mechanical Characteristics

- Mating / Un-mating : 500 Cycles

#### Electrical Characteristics

- Normal Impedance: 50 OHMS
- Frequency Range : 0-1 GHz
- Testing Voltage : 500 Volts RMS
- Dielectric Withstanding Voltage : 1500 Volts RMS
- Insulation Resistance : 5000 Megohms Min

#### Environmental Characteristics

- Temperature Range: -40°C to +60°C
- Thermal Shock: MIL-STD-107, Method 204, Cond. B
- Physical Shock: MIL-STD-202, Method 204, Cond. B