

REV.	ECN NO.	DATE	SIGN	DESCRIPTION
B	LEN1560170	2015/06/01	Ruru	Change Logo

THIS DOCUMENT IS SUBJECT TO CHANGE WITHOUT NOTICE. IT IS CONFIDENTIAL AND A PROPERTY OF AMPHENOL LTW. DISCLOSURE TO THIRD PARTY HAS TO BE AUTHORIZED BY AMPHENOL LTW.

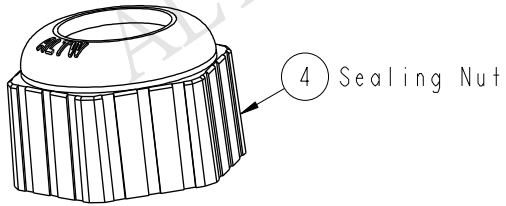

4 Sealing Nut

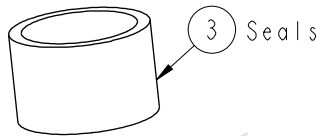

3 Seals

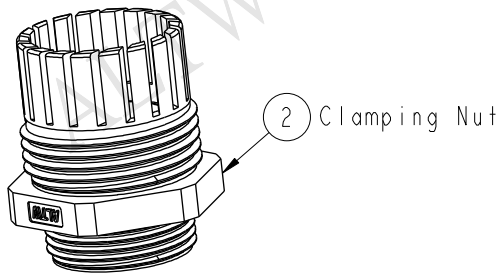

2 Clamping Nut

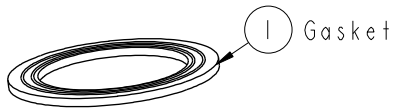

1 Gasket

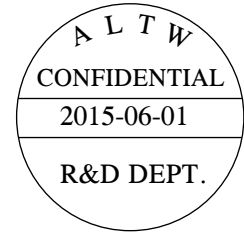
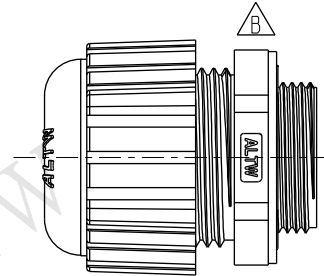
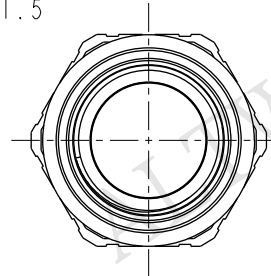
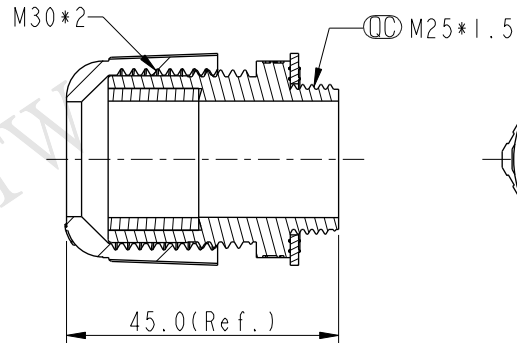
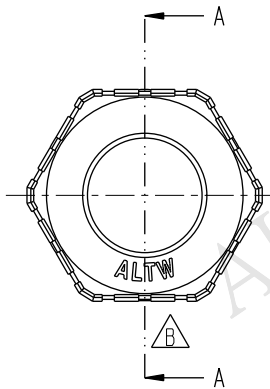
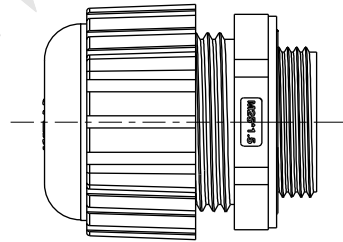

- Note:
- * Waterproof Rate: IP68
 - * Gasket: EPDM, Black
 - * Clamp Ring: Nylon, Gray
 - * Seals: EPDM, Black
 - * Sealing Nut: Nylon, Gray
 - * Cable Range: $\varnothing 13.0 \sim \varnothing 18.0$

UNIT: mm		
TOLERANCE	.X	± 0.25
	.XX	± 0.1
	.XXX	± 0.05
ANGLES		$\pm 1^\circ$

TITLE M25 Cable Gland Assy Gray For Short Type			
SCALE 1:1	SIZE A4	SHEET 1 OF 1	
REV. B	WC-REV. A.1	QC: Inspection item	

Amphenol LTW
安費諾亮泰企業股份有限公司

ITEM NO. CSG-25M004	DRAWN BY Ruru	DATE 2015-06-01
DWG NO. CSG-25M004	CHECKED BY Rita	DATE 2015-06-01
CUSTOMER ALTW	APPROVED BY Lion	DATE 2015-06-01