

THIS DOCUMENT IS SUBJECT TO CHANGE WITHOUT NOTICE. IT IS CONFIDENTIAL AND A PROPERTY OF Amphenol LTW. DISCLOSURE TO THIRD PARTY HAS TO BE AUTHORIZED BY Amphenol LTW.

| REV. | ECN NO. | DATE | SIGN | DESCRIPTION |
|------|---------|------------|------|------------------|
| B | E191899 | 2019/11/15 | Ruru | $\triangle B$ X4 |
| | | | | |

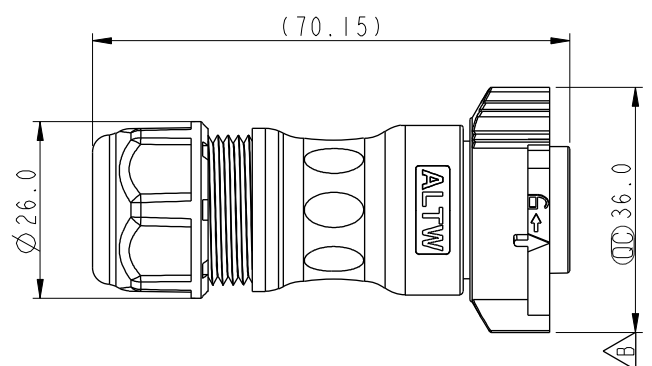
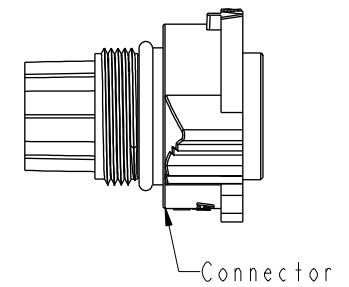
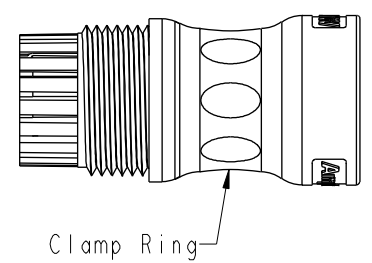
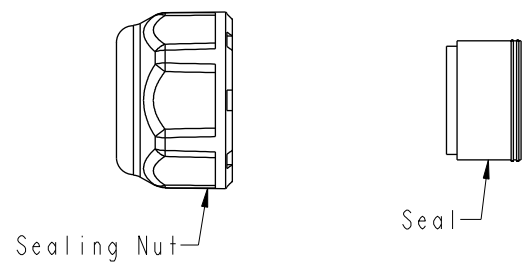

DC-XXBFMA-QL8XPP

02-2 Pin

03-3 Pin

05-5 Pin

S: With Red Color Seal 1, Cable OD 6.0~8.0mm.
M: With Yellow Color Seal 2, Cable OD 8.0~10.0mm.
L: With Blue Color Seal 3, Cable OD 10.0~12.0mm.
A: With Seal 1 & Seal 2 & Seal 3.

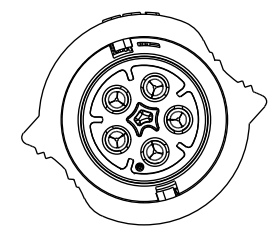
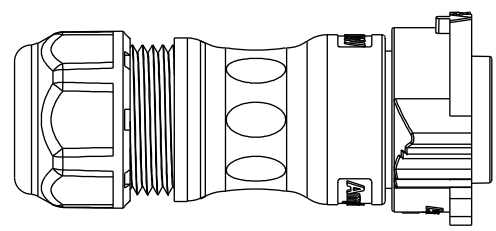

$\triangle B$ Note:

- * ϕ Important Dimension
- * Waterproof Rate: IP68, Mated
- IP68 : IM Depth Of Water In 24hours
- * Housing: Thermoplastic, Black
- * Pin: Copper Alloy, Gold Plated
- * Clamp Ring: Thermoplastic, Black
- * Sealing Nut: Thermoplastic, Black
- * Seals: Rubber

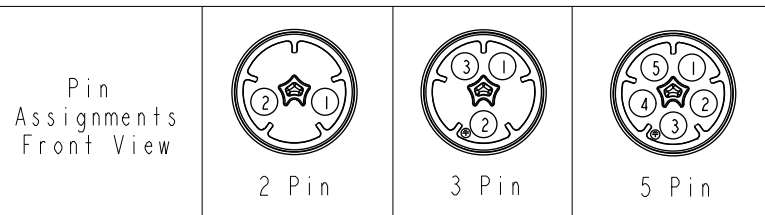

| | | | | | | | |
|--------------------------------------|--|---------------|-------------------------------|--|------------------|--------------------|--|
| UNIT:mm TOLERANCE ± 0.5 mm | TITLE XLOK, D-20A, CABLE W/O SR F, M, FI CRIMP, XLOK $\triangle B$ | | Amphenol LTW 安費諾亮泰企業股份有限公司 | | ITEM NO | DRAWN BY Ruru | DATE 2019-11-15 |
| | SCALE 1:1 | SIZE A4 | | | SHEET 1 | OF 1 | DWG NO DC-XXBFMA-QL8XPP $\triangle B$ |
| | REV. B | WC-REV. .0 | ϕ Inspection item | | CUSTOMER ALTW | APPROVED BY Max | DATE 2019-11-15 |