

THIS DOCUMENT IS SUBJECT TO CHANGE WITHOUT NOTICE. IT IS CONFIDENTIAL AND A PROPERTY OF AMPHENOL LTW. DISCLOSURE TO THIRD PARTY HAS TO BE AUTHORIZED BY AMPHENOL LTW.

REV.	ECN NO.	DATE	SIGN	DESCRIPTION
A	Initial Release	2009/09/08	Doreen	Change REV.01 to REV.A
B	C200482	2020/04/15	Ruru	$\triangle B$ X2

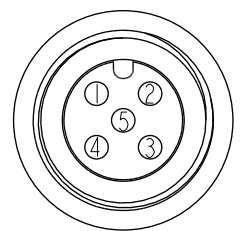

Conn.1&2&3
Pin Assignments
Front View

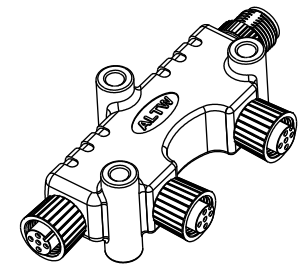
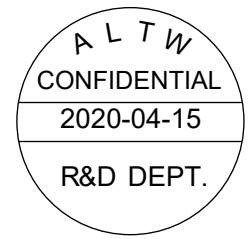
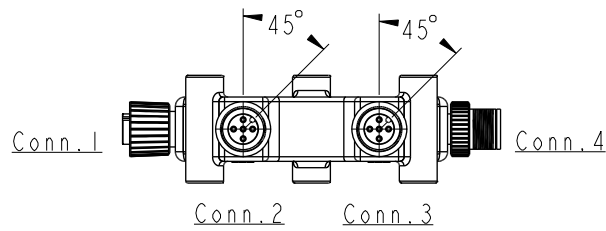
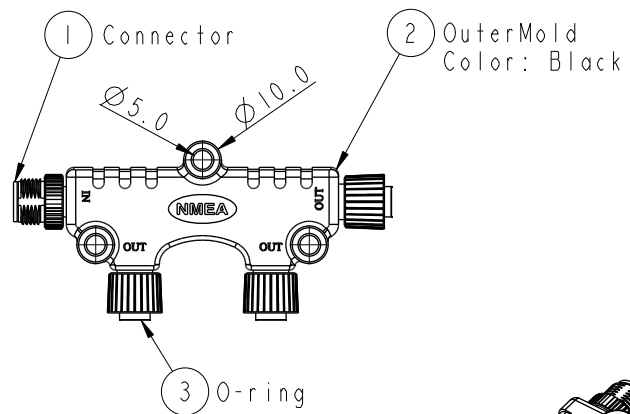
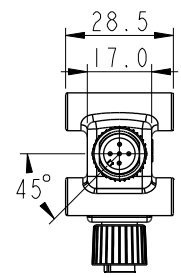
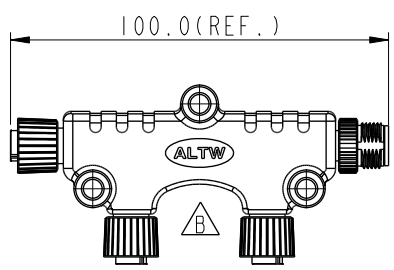
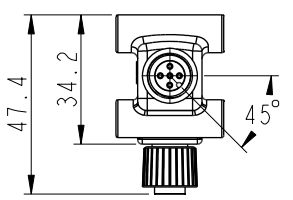
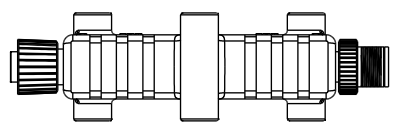
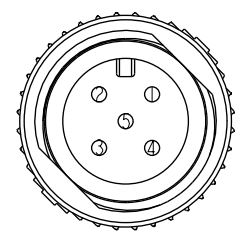

Conn.4
Pin Assignments
Front View

Blue 藍 (22AWG)	5	5
White 白 (22AWG)	4	4
Black 黑 (22AWG)	3	3
Red 紅 (22AWG)	2	2
Green 綠 (22AWG)	1	1
Wire Color	Conn.1	Conn.4
	Pin Out	

Note:
 * \varnothing Important Dimension.
 * Waterproof Rate: IP68.
 * Connector: NY+GF, PU, Black.
 * O-Ring: Silicone, Gray.
 * Nut: Zinc Alloy, Nickel Plated.
 * Pin: Copper Alloy, Gold Plated.
 * Wire Harness: UL1007/TR64 22AWG, OD=0.76mm, Green, White, Blue, Red, Black.
 * Text Depth : 0.3 mm

UNIT:mm	\varnothing	∇
TOLERANCE	± 0.5 $\triangle B$	

TITLE NMEA2000 MICRO-C 2-WAY TEE			
SCALE 1:2	SIZE A4	SHEET 1 OF 1	
REV. B	WC-REV. A.1	\varnothing : Inspection item	

Amphenol LTW
 安費諾亮泰企業股份有限公司

ITEM NO	DRAWN BY SamChang	DATE 2013-07-04
DWG NO E-555500-FFF00-S001	CHECKED BY Jeffrey	DATE 2013-12-17
CUSTOMER ALTW	APPROVED BY Rita	DATE 2013-12-17