

THIS DOCUMENT IS SUBJECT TO CHANGE WITHOUT NOTICE. IT IS CONFIDENTIAL AND A PROPERTY OF Amphenol LTW. DISCLOSURE TO THIRD PARTY HAS TO BE AUTHORIZED BY Amphenol LTW.

REV.	ECN NO.	DATE	SIGN	DESCRIPTION
B	BOMR18120100	2018/12/12	Ruru	Change the drawing method
C	C201735	2020/11/11	Ruru	$\triangle C$ X7
D	C210227	2021/03/30	Vicky	$\triangle D$ X4

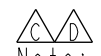
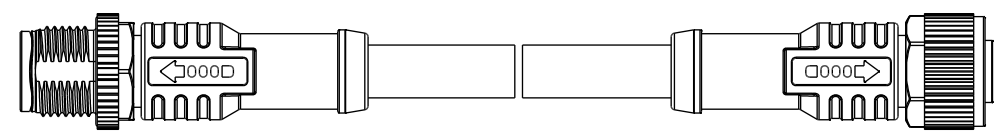
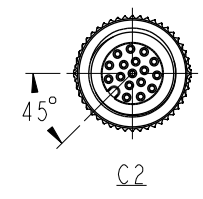
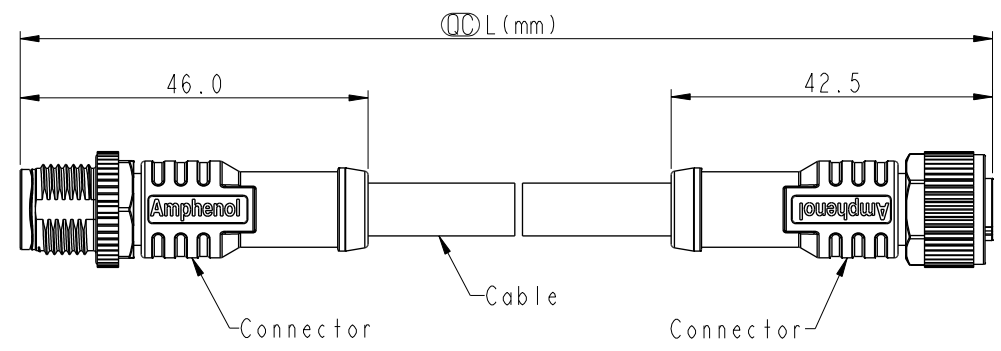
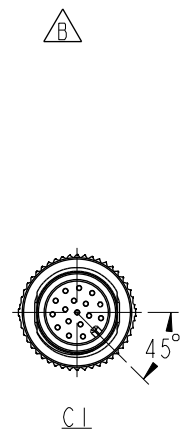

Note:

- * RoHS Compliant
- * \varnothing Important dimension
- * C1
Waterproof rate: IPX8, mated 1m/24h
IPX9K, mated
Housing: Thermoplastic, Black
Pin: Copper alloy, Gold plated
Nut: Metal
Outer Mold: Thermoplastic, Black
- * C2
Waterproof rate: IPX8, mated 1m/24h
IPX9K, mated
Housing: Thermoplastic, Black
Pin: Copper alloy, Gold plated
O-Ring: Rubber, Green
Nut: Metal
Outer Mold: Thermoplastic, Black
- * Cable: UL20549, PUR Jacket, Black
- * Cable Length Tolerance:

0.5M < L ≤ 1M:	+60/-0 mm
1M < L ≤ 3M:	+120/-0 mm
3M < L ≤ 5M:	+160/-0 mm
5M < L ≤ 10M:	±100 mm
10M < L ≤ 20M:	±200 mm
20M < L ≤ 30M:	±300 mm
30M < L ≤ 99M:	±500 mm

UNIT: mm		
TOLERANCE		
±0.5mm		

TITLE ACC, SEN, A Code, DB-ENDED MF			$\triangle D$
SCALE 1:2	SIZE A4	SHEET 1 OF 2	
REV. D	WC-REV.	\varnothing : Inspection item	

Amphenol LTW
安費諾亮泰企業股份有限公司

ITEM NO.	DRAWN BY Ruru	DATE 2018-12-12
DWG NO. \triangle M12AXXML-12AFL-SBXXX	CHECKED BY Rita	DATE 2018-12-12
CUSTOMER ALTW	APPROVED BY Max	DATE 2018-12-12

THIS DOCUMENT IS SUBJECT TO CHANGE WITHOUT NOTICE. IT IS CONFIDENTIAL AND A PROPERTY OF Amphenol LTW. DISCLOSURE TO THIRD PARTY HAS TO BE AUTHORIZED BY Amphenol LTW.

△B	△C MI2AXXML-12AFL-SBXXX				△C	△D			
	XX: No. Of Pin				XXX: 0.5~99Meters A05: 0.5 Meter 1: 01 Meter 2: 02 Meters : 99: 99 Meters	17P 12P 10P 8P 6P 5P 4P 3P	7.0 6.0 4.8 5.0 4.4 4.0 3.8	26 24 22	MI2A17ML-12AFL-SBXXX MI2A12ML-12AFL-SBXXX MI2A10ML-12AFL-SBXXX MI2A08ML-12AFL-SBXXX MI2A06ML-12AFL-SBXXX MI2A05ML-12AFL-SBXXX MI2A04ML-12AFL-SBXXX MI2A03ML-12AFL-SBXXX
					Contacts	Cable OD	AWG	Item No.	

△B	△C MI2AXXML-12AFL-SBXXX				△C	△D			
	XX: No. Of Pin				XXX: 0.5~99Meters A05: 0.5 Meter 1: 01 Meter 2: 02 Meters : 99: 99 Meters	17P 12P 10P 8P 6P 5P 4P 3P	7.0 6.0 4.8 5.0 4.4 4.0 3.8	26 24 22	MI2A17ML-12AFL-SBXXX MI2A12ML-12AFL-SBXXX MI2A10ML-12AFL-SBXXX MI2A08ML-12AFL-SBXXX MI2A06ML-12AFL-SBXXX MI2A05ML-12AFL-SBXXX MI2A04ML-12AFL-SBXXX MI2A03ML-12AFL-SBXXX
					Contacts	Cable OD	AWG	Item No.	
Pin Out	5 -- 4 Black 3 Blue 2 -- 1 Brown	5 -- 4 Black 3 Blue 2 White 1 Brown	5 Gray 4 Black 3 Blue 2 White 1 Brown	8 -- 7 Blue 6 Pink 5 -- 4 Yellow 3 Green 2 Brown 1 White	8 Red 7 Blue 6 Pink 5 Gray 4 Yellow 3 Green 2 Brown 1 White	12 -- 11 -- 10 Violet 9 Black 8 Red 7 Blue 6 Pink 5 Gray 4 Yellow 3 Green 2 Brown 1 White	12 Red/Blue 11 Gray/Pink 10 Violet 9 Black 8 Red 7 Blue 6 Pink 5 Gray 4 Yellow 3 Green 2 Brown 1 White	17 White/Gray 16 Yellow/Brown 15 White/Yellow 14 Brown/Green 13 White/Green 12 Red/Blue 11 Gray/Pink 10 Violet 9 Red 8 Gray 7 Black 6 Yellow 5 Pink 4 Green 3 White 2 Blue 1 Brown	
Pin #	Wire	Pin #	Wire	Pin #	Wire	Pin #	Wire	Pin #	Wire

Pin Assignments Front View

UNIT: mm			TITLE ACC, SEN, A Code, DB-ENDED MF	Amphenol LTW 安費諾亮泰企業股份有限公司	ITEM NO MI2AXXML-12AFL-SBXXX	DRAWN BY Ruru	DATE 2018-12-12
TOLERANCE ±0.5mm			SCALE 1:2	SIZE A4	SHEET 2 OF 2	CHECKED BY Rita	DATE 2018-12-12
			REV. D	WC-REV.	CC: Inspection item	APPROVED BY Max	DATE 2018-12-12