

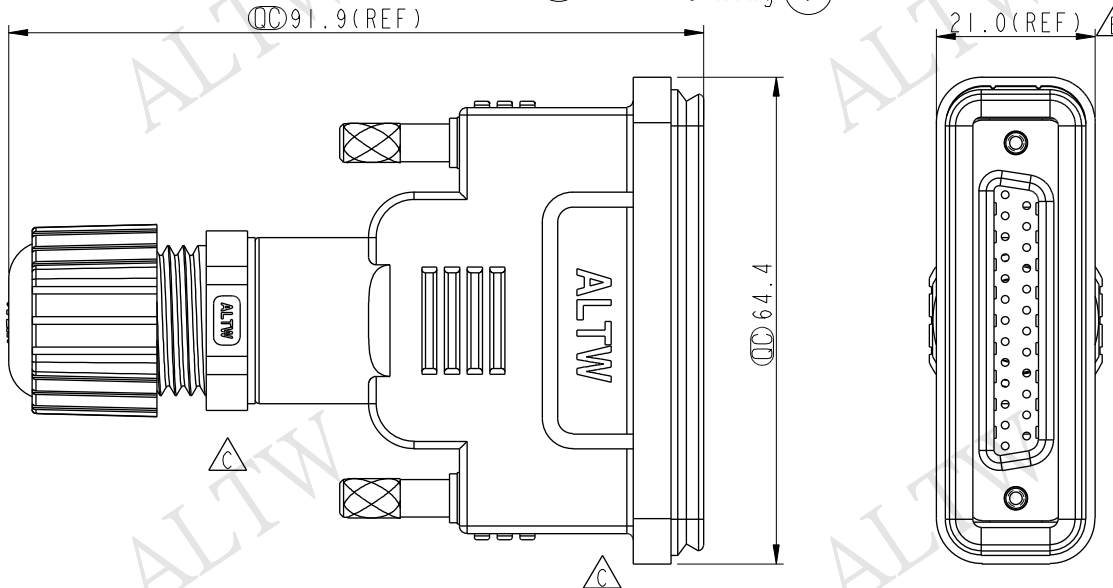

REV.	ECN NO.	DATE	SIGN	DESCRIPTION
B	LEN1160164	2011/05/07	Jiang Jun Hua	Change 21.0 To 21.0(Ref)
C	LEN1560185	2015/04/08	Ruru	Change Logo

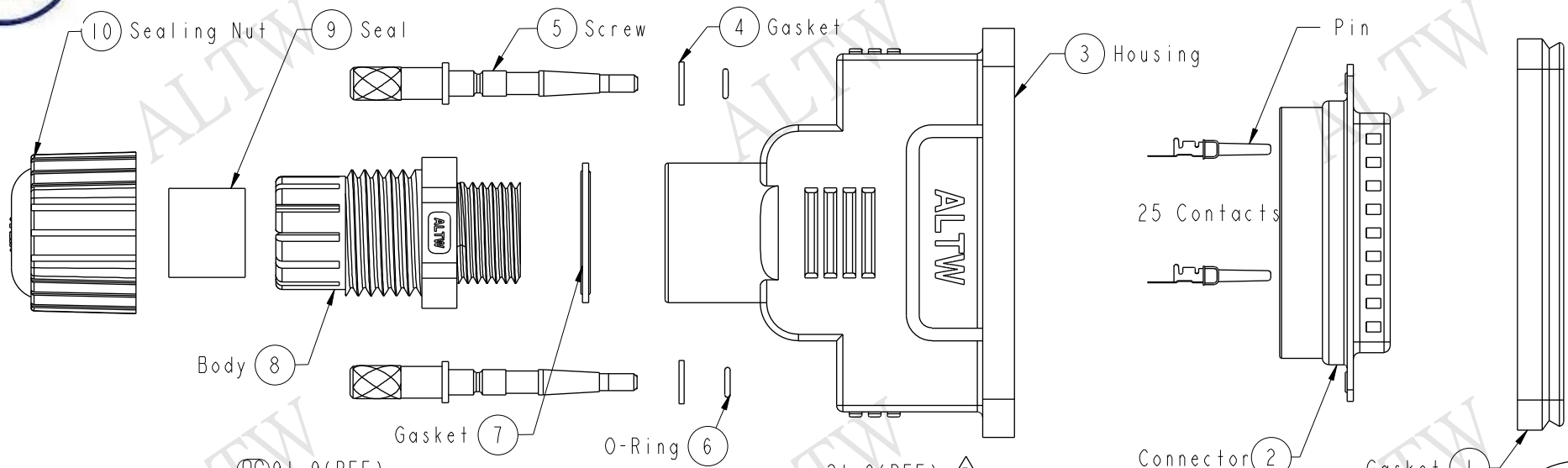

- Note:
- * \varnothing Important Dimension
 - * Waterproof Rate: IP67
 - * Gasket: EPDM, Black
 - * Connector: D-SUB 25Pin Female
 - * Female Pin: Copper Alloy, Gold Plated
 - * Housing: ABS 94V-0, Black
 - * Screw: Brass, Nickel Plated
 - * O-Ring: Silicone
 - * Body: Nylon, Black
 - * Seals: EPDM, Black
 - * Sealing Nut: Nylon, Black
 - * Seals for Cable OD: $\varnothing 6.0\text{mm} \sim \varnothing 10.0\text{mm}$
 - * One Set Unassembled in PE Bags
 - * Pins are Purchased Separately, PN: BBA0140GOXX

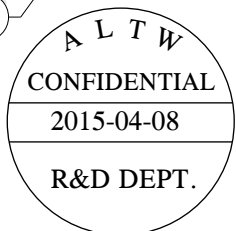

UNIT:mm	
TOLERANCE	$\pm 0.5 \text{ mm}$

TITLE D-SUB Conn Assy Screw DB25Pin F Conn F Pin			
SCALE 1:1	SIZE A4	SHEET 1 OF 1	
REV. C	WC-REV. A.2	\varnothing : Inspection item	

Amphenol LTW
安費諾亮泰企業股份有限公司

ITEM NO SDB-25BFFC-SL7001	DRAWN BY Ruru	DATE 2015-04-08
DWG NO SDB-25BFFC-SL7001	CHECKED BY Rita	DATE 2015-04-08
CUSTOMER ALTW	APPROVED BY Lion	DATE 2015-04-08

THIS DOCUMENT IS SUBJECT TO CHANGE WITHOUT NOTICE. IT IS CONFIDENTIAL AND A PROPERTY OF Amphenol LTW. DISCLOSURE TO THIRD PARTY HAS TO BE AUTHORIZED BY Amphenol LTW.